

**WICHTIG:**  
Vor Gebrauch  
lesen

**IMPORTANT:**  
Read before  
using

**IMPORTANTE:**  
Lea antes de  
usar

**IMPORTANT:**  
Lire avant  
usage

**IMPORTANT:**  
leggere prima  
dell'uso

**BELANGRIJK:**  
lees voor  
gebruik

**VIKTIG:**  
Les før du  
bruker

**VIKTIG:**  
Läs innan du  
använder

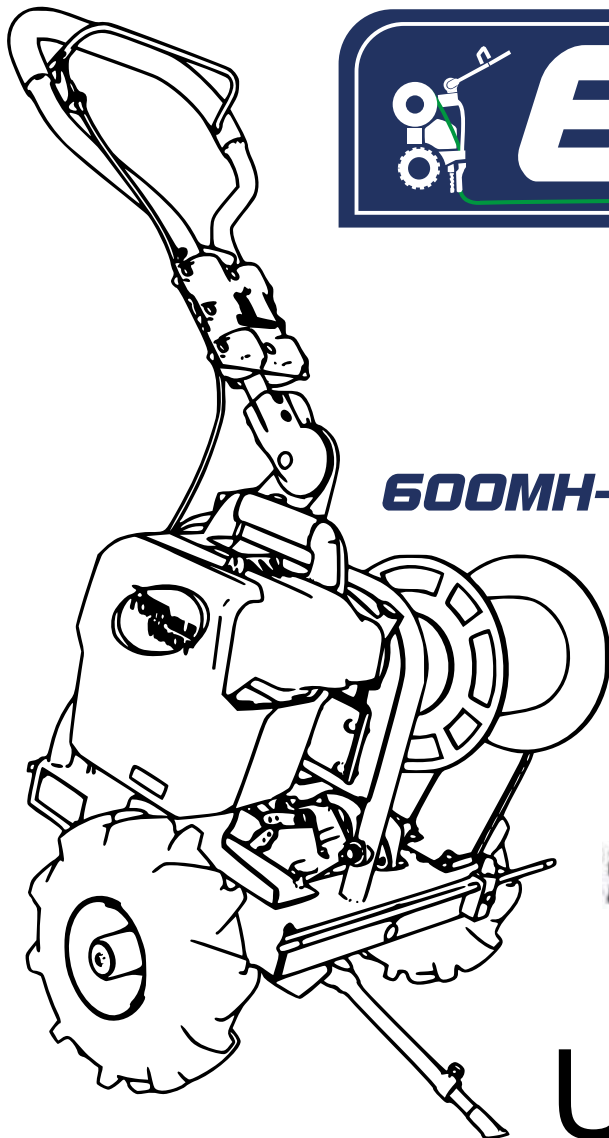

CABLE LAYING MACHINE  
MACHINE À FILS  
KABELVERLEGUNGSMASCHINE

**600MH-Li**

**80/82 VOLT**  
82V MAX LITHIUM ION

# USER GUIDE



DE  
EN  
ES  
FR  
IT  
NL  
NO  
SV



**Betriebs-/Sicherheitshinweise**  
**Operating/safety Instructions**  
**Instrucciones de operación / seguridad**  
**Consignes de fonctionnement/sécurité**  
**Istruzioni per l'uso e la sicurezza**  
**Gebruiksaanwijzing / Veiligheidsvoorschriften**  
**Bruksanvisning / sikkerhet**  
**Bruksanvisning / säkerhet**

[www.600mh.info](http://www.600mh.info)

**WICHTIG:**  
Vor Gebrauch  
lesen

**IMPORTANT:**  
Read before  
using

**IMPORTANTE:**  
Lea antes de  
usar

**IMPORTANT:**  
Lire avant  
usage

**IMPORTANT:**  
leggere prima  
dell'uso

**BELANGRIJK:**  
lees voor  
gebruik

**VIKTIG:**  
Les før du  
bruker

**VIKTIG:**  
Läs innan du  
använder

## INTRODUCTION

Portable Winch Co. wishes to thank you for purchasing a Perimeter Wire Machine 600MH-Li™. This manual was written to help you make the best use of your new machine and to use it in the most secure way.

### PLEASE READ CAREFULLY BEFORE USE.

For any problems or questions, please contact an authorized Portable Winch Co. dealer or contact us directly.







## 1 Safety guidelines

The Perimeter Wire Machine 600MH-Li™ is designed to bury electrical wires up to 6 mm in diameter at a depth of between 4 and 6 cm in grassy soil. The use of this machine implies serious risks of injury, property damage or even death. **Do not underestimate its potential danger.**

### 1.1 Safety messages

Your safety and the safety of others are very important. You will find important safety messages in this manual. **Please read them carefully.**

These security messages warn you of potential injuries to either yourself or others. Each safety message is preceded by a warning symbol.

SYMBOL	SIGNIFICATION
	YOU WILL BE FATALLY OR SERIOUSLY INJURED IF YOU DO NOT FOLLOW THESE INSTRUCTIONS.
	YOU COULD BE FATALLY OR SERIOUSLY INJURED IF YOU DO NOT FOLLOW THESE INSTRUCTIONS.
	YOU COULD BE INJURED IF YOU DO NOT FOLLOW THESE INSTRUCTIONS.
	READ THE USER GUIDE.
	EYE AND HEARING PROTECTION.
	WEAR GLOVES

### 1.2 Environmental protection



End-of-life electrical products must not be disposed of with household waste. Recycle them through the establishments available. Contact the local authorities for more information on recycling conditions.

The battery contains materials which are harmful to you and the environment. It must be removed and disposed of separately at a collection point that accepts lithium-ion batteries.

## 1.3 Battery and charger (Sold separately)

**PRECAUTION** CHARGE THE BATTERY IN A DRY ENVIRONMENT PROTECTED FROM THE WEATHER. DO NOT EXPOSE THE BATTERY OR CHARGER TO RAIN.

**ATTENTION** NEVER CHARGE THE BATTERY IN A DAMP ENVIRONMENT. USE THE CHARGER AT TEMPERATURE BETWEEN 7 AND 40 °C (45 AND 104 °F). TO REDUCE THE RISKS OF ELECTRIC SHOCK, ONLY USE THE CHARGER PROVIDED BY THE MANUFACTURER TO CHARGE THE BATTERY; NEVER STORE THE TOOL OUTDOORS. HANDLE THE CHARGER'S POWER CABLE WITH CARE.

**PRECAUTION** NEVER CARRY THE CHARGER HOLDING ITS WIRE.

**ATTENTION** IF THE TOOL IS USED INTENSIVELY OR UNDER EXTREME TEMPERATURES, BATTERY LEAKS MAY OCCUR. IF THE LIQUID COMES INTO CONTACT WITH YOUR SKIN, RINSE THE AFFECTED AREA IMMEDIATELY WITH SOAPY WATER. IN CASE OF CONTACT WITH YOUR EYES, RINSE WITH CLEAN WATER FOR AT LEAST 10 MINUTES THEN CONTACT A DOCTOR IMMEDIATELY. RESPECTING THIS RULE WILL REDUCE THE RISK OF SERIOUS INJURIES.

**PRECAUTION** NEVER UNPLUG THE CHARGER FROM THE MAINS BY PULLING ON THE POWER CABLE.

**ATTENTION** NEVER CRUSH, DROP OR DAMAGE THE BATTERY. NEVER USE A BATTERY OR CHARGER THAT HAS BEEN DROPPED, CRUSHED, RECEIVED A VIOLENT SHOCK OR BEEN DAMAGED IN ANY WAY WHATSOEVER. A DAMAGED BATTERY RISKS EXPLODING. DISPOSE OF A DAMAGED BATTERY IMMEDIATELY USING AN APPROPRIATE METHOD.

**PRECAUTION** WHEN THE BATTERY IS NOT IN USE, KEEP IT AWAY FROM METAL OBJECTS SUCH AS: PAPER CLIPS, COINS, KEYS, NAILS, SCREWS AND OTHER SMALL METAL OBJECTS.

**ATTENTION** DO NOT USE THE CHARGER IF IT IS DAMAGED. REPLACE THE CHARGER OR ITS CABLES IMMEDIATELY.

**PRECAUTION** KEEP THE CHARGER AWAY FROM WATER, HEAT SOURCES (RADIATORS, HEATERS, STOVES, ETC), FLAMES AND CHEMICAL PRODUCTS.

**ATTENTION** NEVER USE ANY WIRELESS DEVICE IN THE PRESENCE OF AN OPEN FLAME.

**PRECAUTION** MAKE SURE THAT THE BATTERY IS SECURE IN THE CHARGER BEFORE USING IT.

**PRECAUTION** THE BATTERY WILL WARM UP SLIGHTLY DURING CHARGING. THIS IS NORMAL AND DOES NOT INDICATE A PROBLEM.

**PRECAUTION** NEVER PLACE THE CHARGER IN A LOCATION EXPOSED TO EXTREME TEMPERATURES (HOT OR COLD). IT WORKS BEST AT ROOM TEMPERATURE.

**PRECAUTION** WHEN THE BATTERY IS FULLY CHARGED, UNPLUG THE CHARGER FROM THE MAINS AND REMOVE THE BATTERY.

**PRECAUTION** KEEP THE BATTERY CLEAN, DRY AND FREE OF OIL AND GREASE. ALWAYS USE A CLEAN CLOTH FOR CLEANING. NEVER USE BRAKE FLUID, PETROL, OIL-BASED PRODUCTS OR ANY SOLVENT TO CLEAN THE BATTERY.

### 1.3.1 Compatible Batteries (Sold separately)

**ATTENTION** 80V AND 82V BATTERIES MADE BY GLOBE TOOLS CAN BE USED IN YOUR PERIMETER WIRE MACHINE 600MH-LI™.

Here is a non-exhaustive list of compatible battery models:

- GREENWORKS PRO 80V – 2Ah.
- GREENWORKS PRO 80V – 4Ah.
- GREENWORKS COMMERCIAL 82V – 2.5Ah.
- GREENWORKS COMMERCIAL 82V – 5Ah.
- POWERWORKS 82V – 2.5Ah.
- POWERWORKS 82V – 5Ah.
- CRAMER 82V – 3Ah.
- CRAMER 82V – 6Ah.
- STIGA VOLTAGE 80V – 2.5Ah.
- STIGA VOLTAGE 80V – 4Ah.
- STIGA VOLTAGE 80V – 5Ah.
- BRIGGS & STRATTON 82V MAX – 2Ah.
- BRIGGS & STRATTON 82V MAX – 4Ah.
- BRIGGS & STRATTON 82V MAX – 5Ah.

Visit our website [www.600mh.info](http://www.600mh.info) for the list of compatible batteries or contact us.

#### 1.4 Label

##### 1.4.1 Serial number label

The serial number label can be found on the right rear of the machine. In addition to the serial number, the fundamental specifications of your model are also found there.

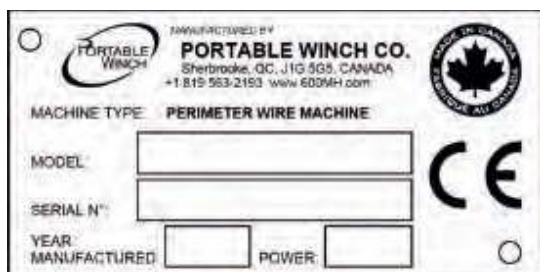

##### 1.4.2 Engine label



##### 1.4.3 Personal protection equipment label



The label indicates that it is highly recommended to wear the following:

- Safety glasses with deflectors
- Hearing protection;
- Protective gloves
- Steel toe-capped shoes.

##### 1.4.4 Read the user manual label

The read the user manual label indicates that it is necessary to read the entirety of this manual before using the machine.



#### 1.4.5 Warning label for potential dangers of the blade

EN



This warning label informs you of the following potential dangers:

- Debris can fly out and cause injuries to the eyes;
- The blade can crush feet;
- The blade can crush hands;
- The blade can cut hands.

#### 1.4.6 Safety information

**DANGER** BEFORE STARTING ANY PERIMETER WIRE LAYING WORK, MAKE SURE YOU KNOW THE LOCATIONS OF ANY ELECTRICAL WIRES OR WATER PIPES IN THE WORK ZONE.

**ATTENTION** THE MACHINE WEIGHS 31.5 KG. BE CAREFUL WHEN TRYING TO LIFT IT. IT IS HIGHLY RECOMMENDED TO LIFT IT WITH A SECOND PERSON.

**ATTENTION** NEVER LET AN UNTRAINED PERSON USE THE MACHINE. MAKE SURE THAT THEY ARE AWARE OF THE SAFETY AND USAGE INSTRUCTIONS AND HAVE READ THIS MANUAL.

**PRECAUTION** ONLY RESPONSIBLE ADULTS WHO HAVE READ THESE INSTRUCTIONS ARE AUTHORISED TO OPERATE THE MACHINE. DO NOT ALLOW CHILDREN TO OPERATE IT.

**PRECAUTION** KEEP CHILDREN, SPECTATORS AND ANIMALS OUTSIDE OF THE WORK ZONE. STOP THE MACHINE WHEN SOMEONE ENTERS THE WORK ZONE.

**ATTENTION** DO NOT PLACE YOUR FEET NEAR THE BLADE WHILE THE ENGINE IS RUNNING.

**ATTENTION** ENSURE THAT YOUR CLOTHING CANNOT GET CAUGHT IN THE MOVING PARTS OF THE MACHINE.

**PRECAUTION** CLEAN AND/OR REPLACE ALL SECURITY LABELS THAT ARE DIRTY, DETERIORATED, UNREADABLE OR TORN.

**PRECAUTION** ALWAYS WEAR SAFETY GLASSES WITH DEFLECTORS WHEN USING THE MACHINE.

**PRECAUTION** ALWAYS WEAR GLOVES WHEN USING THE MACHINE.

**PRECAUTION** ALWAYS WEAR HEARING PROTECTION WHEN USING THE MACHINE.

**PRECAUTION** ALWAYS WEAR STEEL TOE-CAPPED SHOES WHEN USING THE MACHINE.

**PRECAUTION** DO NOT BACK UP THE MACHINE UNLESS ABSOLUTELY NECESSARY. ALWAYS CHECK THE GROUND AND BEHIND YOU BEFORE MOVING.

**PRECAUTION** CLEAR THE WORK ZONE OF OBJECTS SUCH AS SMALL STONES, TOYS, METAL WIRES, STICKS, ETC. THEY CAN BE CUT AND/OR LIFTED AND PROJECTED BY THE BLADE.

**PRECAUTION** NEVER USE THE MACHINE IF THE PROTECTION GUARDS AND OTHER SAFETY DEVICES ARE NOT IN PLACE.

**PRECAUTION** STOP THE ENGINE WHEN CROSSING DRIVEWAYS, SIDEWALKS OR STREETS.

**DANGER** DO NOT USE THE MACHINE IF YOU ARE UNDER THE INFLUENCE OF ALCOHOL OR DRUGS.



**⚠ DANGER** NEVER USE THE MACHINE ON WET GRASS. WALK AT A STEADY PACE, HOLD ON TO THE HANDLE AND WALK NEVER RUN.

**⚠ PRECAUTION** IF THE MACHINE STARTS TO VIBRATE ABNORMALLY, STOP THE ENGINE AND CHECK IMMEDIATELY FOR THE CAUSE. STRONG VIBRATIONS ARE USUALLY A SIGN SOMETHING IS WRONG.

**⚠ DANGER** STOP THE ENGINE BEFORE CLEANING, INSPECTION OR REPAIRS.

**⚠ PRECAUTION** BOLTS AND NUTS, ESPECIALLY THE BOLTS USED TO ATTACH THE BLADE SHOULD ALWAYS BE PROPERLY TIGHTENED. KEEP THE MACHINE IN GOOD CONDITION.

**⚠ DANGER** NEVER TAMPER WITH SAFETY DEVICES. REGULARLY CHECK THEY ARE WORKING PROPERLY.

**⚠ PRECAUTION** KEEP GRASS, LEAVES OR DEBRIS OF ANY KIND FROM ACCUMULATING ON THE MACHINE OR IN FRONT OF THE BLADE. CLEAN OIL OR FUEL SPILLAGES.

**⚠ PRECAUTION** ALLOW THE MACHINE TO COOL BEFORE STORING IT.

**⚠ PRECAUTION** IF YOU HIT AN OBJECT, STOP THE MACHINE AND CHECK FOR DAMAGE. BEFORE RESTARTING, REPAIR THE DAMAGE IF NECESSARY.

**⚠ PRECAUTION** THE MACHINE'S BLADE CAN CUT. WRAP THE BLADE OR WEAR GLOVES AND BE CAREFUL WHEN PERFORMING MAINTENANCE ON THE BLADE.

**2. Checks before use**

**2.1 Upon reception**

Inspect the box to detect any obvious damage. If a part is missing or damaged, notify the carrier immediately. Please refer to the assembly manual for the contents of your machine.

**2.2 Assembly and start-up**

**2.2.1 Assembly**

The *Perimeter Wire Machine 600MH-Li™* was completely assembled at the factory except for the following parts: blade, wire guide, sliding foot, blade pulley cover, wheels and handle. To ensure safe and appropriate operation, these parts must be attached securely. Use the **appropriate wrench** to ensure they are tightened sufficiently.

To assemble the components mentioned above, please follow the instructions in the **600MH-Li USER MANUAL**.

**⚠ IT IS ESSENTIAL THAT ALL OF THE STEPS ARE CARRIED OUT**



**2.2.2 Battery (sold separately)**

**⚠ PRECAUTION** THE BATTERY IS HALF-CHARGED AT THE TIME OF PURCHASE. BEFORE USING YOUR MACHINE FOR THE FIRST TIME, FOLLOW ALL THE INSTRUCTIONS AND GUIDELINES INDICATED IN THE BATTERY AND CHARGER MANUFACTURER GUIDES. REMOVE THE BATTERY BEFORE STORING THE MACHINE FOR AN EXTENDED PERIOD. FULLY CHARGE THE BATTERY BEFORE USING THE MACHINE AGAIN. THIS BATTERY HAS NO MEMORY EFFECT.

**2.2.3 Installing the battery**

EN

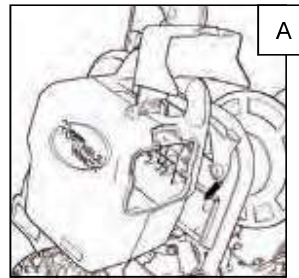

A) Open the battery's protective cover.

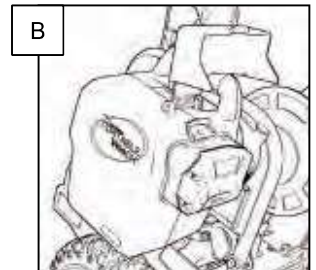
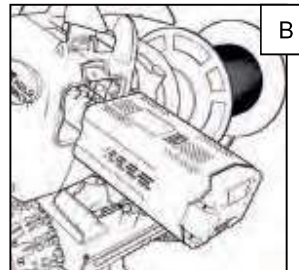

B) Insert the battery (plastic part towards the compartment).

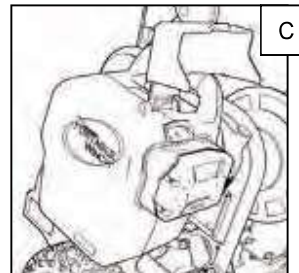

C) Press the battery in until you hear a "click".

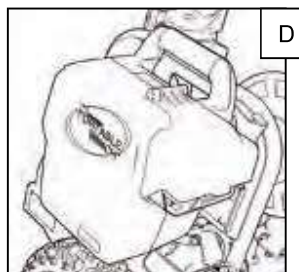

D) Close the cover.

**2.2.4 To remove the battery**

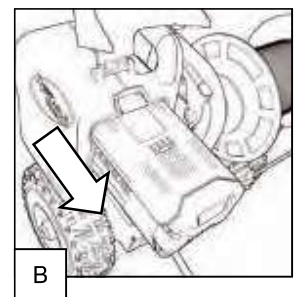
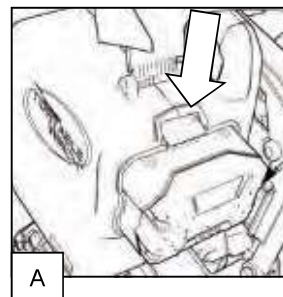

A) Press the battery release button located above the battery. This allows the battery to easily be removed from the device.

B) Remove the battery.



## 2.2.5 Starting the motor

The controls can be found on the motor's housing, above the battery cavity.

- A)  Operating the unit: Press twice to turn on and press again to turn off.
- B)  Press to select the speed of the motor.

Once = slow  
Twice = medium  
Three times = fast

Note : A higher speed reduces the battery's operating time.



**PRECAUTION** THE LITHIUM-ION BATTERY IS FITTED WITH AN INTERNAL BREAKER WHICH AUTOMATICALLY STOPS THE MACHINE IN CASE OF OVERLOAD. IF THIS HAPPENS, TURN THE DEVICE OFF BY PRESSING BUTTON "A" (SEE ILLUSTRATION).

## 3. Usage

**PRECAUTION** ITS COMPACT SIZE AND LIGHT WEIGHT MEAN THE PERIMETER WIRE MACHINE 600MH-Li™ CAN BE EASILY TRANSPORTED IN A SMALL VEHICLE. REMOVING THE BATTERY IS HIGHLY RECOMMENDED WHEN DOING THIS.

Before each use•:

- Check the soil consistency and the deepest possible insertion depth.
- Check the blade attachment.
- Check the attachment of the wire guide.
- Check the tire pressure.

### 3.1 Installing the perimeter wire spool

The *Perimeter Wire Machine 600MH-Li™* is designed to accommodate most wire spools provided by the manufacturers and third party resellers of robot lawnmowers.

**IMPORTANT:** Six stepped spacers are supplied for accommodating spools of different width and center diameters. Select the spacers that will allow for easy insertion of the rod and spool assembly with the most direct path to the wire guide located behind the blade.

#### 3.1.1 Spools mounted on a drum

The hardware provided is suitable for installation of most models up to 800 meters (depending on the wire's diameter):

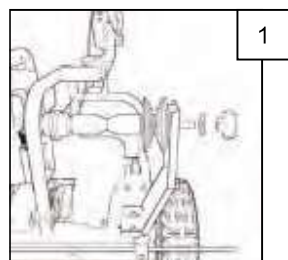

- 1) Unscrew the clamping handle and remove with the flat washer.

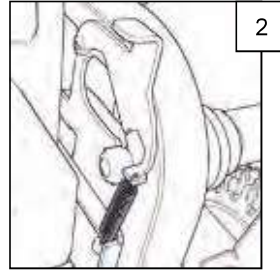

- 2) Lift the shaft while opening the blocker.



- 3) Remove the shaft (with the hardware). Then remove the hardware.

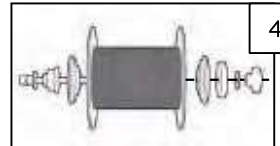

- 4) Insert in the desired order depending on the spool used.

**NOTE:** Make sure the wire is dispensed from the top of the reel.

- Spacer(s);
- The left centering hub (towards the inside of the spool);
- The spool (support at the right level depending on its diameter) on the hub;
- The right centering hub (towards the inside of the spool);
- Spacer(s);
- The rubber washer;

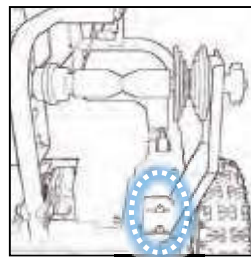

**NOTE:** The spool holding arm may need to be adjusted to fit the spool and to avoid unnecessary turning of the handle when setting the reel tension.

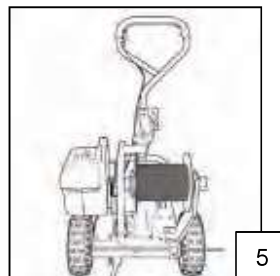

- 5) Insert the shaft by sliding it into the slots provided (arch and adjustable spool support). Return the flat washer and the clamping handle to the shaft. Turn the clamping handle until there is sufficient tension to prevent the spool from free wheeling.

**NOTE:** When the adequate reel tension is set, you can tighten the handle's jam bolt slightly to keep it in position. Do not overtighten to prevent damaging the threads on the rod.

### 3.1.2 Spools without a drum

#### 3.1.2.1 Spools that empty through the center

Some manufacturers supply a spool designed to be emptied through the center. Two (2) PERIMETER WIRE BOXES 18 cm x 18 cm (part PWMA-0002) and 22.5 cm x 22.5 cm (part PWMA-0003), available as optional accessories for the *Perimeter Wire Machine 600MH-Li™*, accepting this type of spool (up to 17.5 cm or 21 cm in diameter, depending on the box used).

#### 3.1.2.2 Spools with no defined shape

Some manufacturers provide wire designed to be wound around the drum manually. As an optional accessory for the *Perimeter Wire Machine 600MH-Li™*, a PERIMETER WIRE DRUM (part PWMA-0001) is available to allow the winding of the wire provided by the manufacturer.

### 3.2 Moving the machine to the work zone

To move the machine to the work zone:

- 1) Loosen the clamping lever on the handle;
- 2) Pivot the handle until it is vertical on the machine.
- 3) Lift the support foot in front the machine.
- 4) Pull or push the machine to the work area.

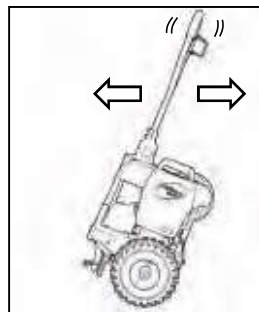

### 3.3 Using the distance guide

The *Perimeter Wire Machine 600MH-Li™* is equipped with an adjustable distance guide. This is used to align the machine with the edge of the course and bury the wire at a distance between 15 cm and 45 cm.

In addition, the distance guide can be placed at the front or back of the machine, depending on user preference.

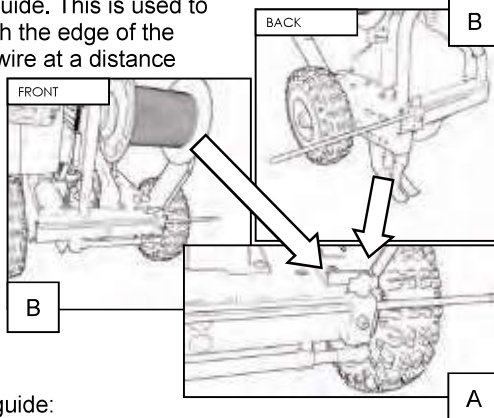

To use the distance guide:

- 1) Unscrew the wing nut (See A);
- 2) Position the distance guide at the desired distance according to the ruler label (on the front or back of the machine). The ruler ensures positioning between 15 and 45 cm to the nearest centimeter. (See B);
- 3) Tighten the wing nut.

### 3.4 Self-propulsion

The *Perimeter Wire Machine 600MH-Li™* is equipped with a transmission for self-propulsion. This allows for a constant rate of installation and considerably reduces operator effort.

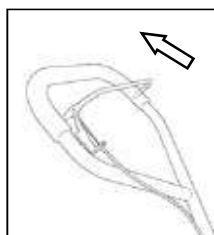

### 3.5 Inserting the perimeter wire in the wire guide

EN

Proceed as follows:

- 1) Pull the end of the wire from the spool;
- 2) Insert the wire in the guide wire tube;
- 3) Push the wire until it emerges;

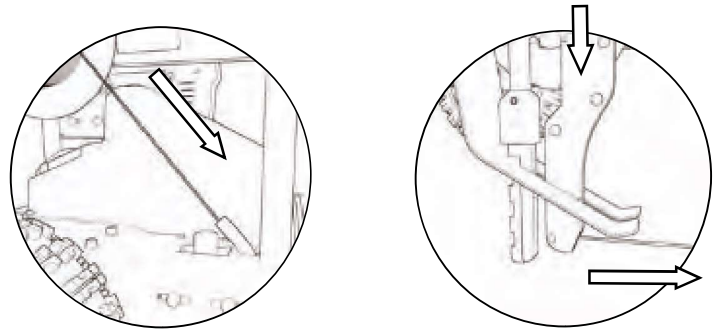

### 3.6 Burying the perimeter wire in the ground

Refer to the manufacturer's instructions of the robot mower for the technical specifications for installing perimeter wire.

Initially, attach the end of the wire to a stake or a tool planted in the ground.

- 1) Start the motor;
- 2) Lift the support foot at the front of the machine;
- 3) Slowly insert the blade into the ground by pressing down on the handle until the frame is parallel to the ground (Figure 1);
- 4) Apply pressure to the traction handle to move the machine (Figure 2).

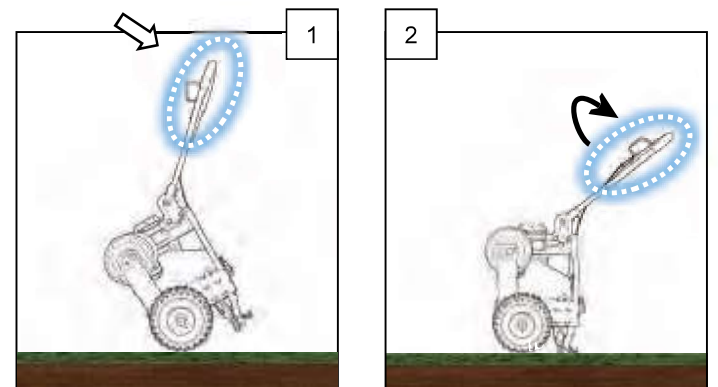

### 3.7 Adjusting the handle height

It is important to adjust the handle height before working with the *Perimeter Wire Machine™*.

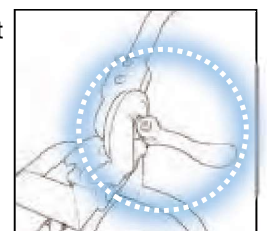
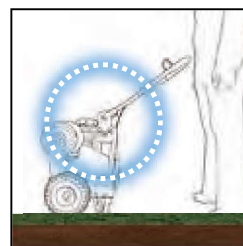

The recommended handle position is at the waist level, but adjust it to your preferred height using the handle clamping lever.



### 3.8 Overcoming obstacles in the ground

When burying the wire in the ground, some immovable obstacles such as large rocks or roots will be encountered. To avoid damage to the blade and/or the machine, follow the instructions below:

**ATTENTION** DO NOT PUSH THE BLADE AGAINST THE OBSTACLE IN AN ATTEMPT TO TRY TO CUT OR DISPLACE IT.

- 1) Release the traction handle (Figure 1);
- 2) Push the handle upwards, trying to keep the blade and the wire guide in the soil (Figure 2, A);
- 3) Lightly press on the traction handle to pass over the obstacle (Figure 2, B);
- 4) Lower the machine so that the frame is parallel to the ground (Figure 3, A);
- 5) Resume the job by pressing the traction handle (Figure 3, B).

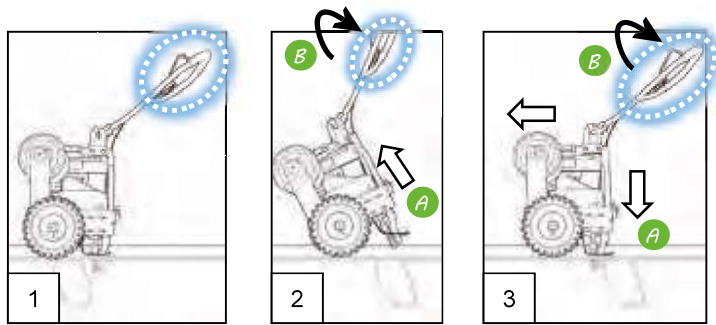

### 3.9 Insertion of perimeter wire in a tight corner

When designing the *Perimeter Wire Machine 600MH- Li™*, every feature has been implemented to allow burying of the wire as close as possible to the perimeter of the field and to avoid having to manually bury the wire. Its compact size and the 15 cm blade offset from the outside of the wheel are good examples. The handle is also designed to quickly and easily pivot as needed to turn tight corners.

Follow the steps below:

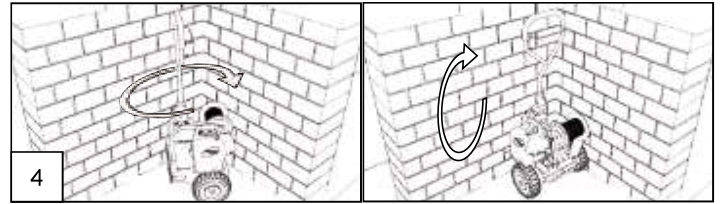
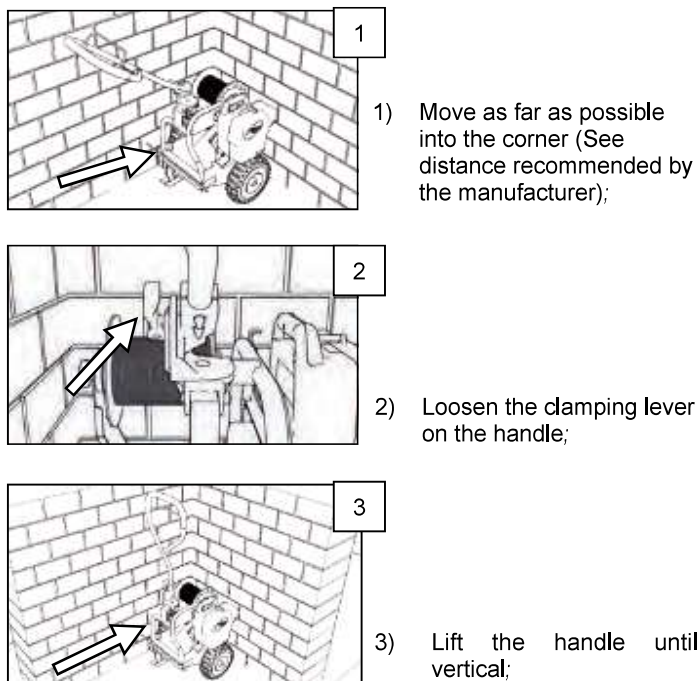

- 4) Turn the machine in the desired direction by grasping the arch;

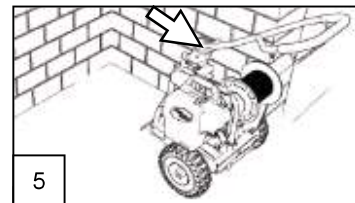

- 5) Lower the handle until horizontal;

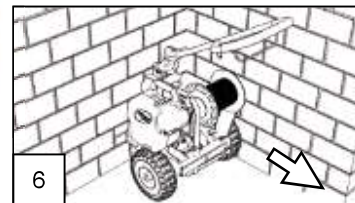

- 6) Place your left hand on the arch and your other hand on the traction lever. Move the machine forward until there is enough room behind to resume the normal working position.

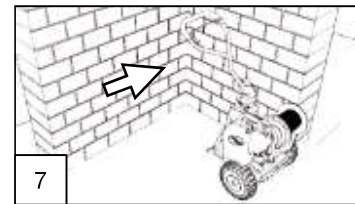

- 7) Once out of the corner, move the handle to the desired position to continue burying the wire.

### 3.10 Transport

The best way to transport the 600MH-Li is to fold the handle forward parallel to the ground. With the foot stand folded, tilt the machine down until the handle is on the floor of the transport vehicle. Secure it with a ratchet strap.

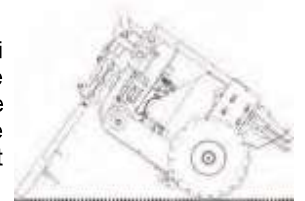

## 4. Maintenance

Some adjustments should be performed periodically to maintain the machine in good working condition. Here is the maintenance schedule:

ACTION	BEFORE/ EVERY					AFTER
	Use	10 hours	25 hours	100 hours	Storage	Use
Check the blade attachment	X					
Check the wire guide attachment	X					
Check the tire pressure	X					
Check the blade	X		X			
Clean the top and bottom of the machine			X		X	X
Clean underneath the guards			X		X	X
Clean the blade attachment system			X		X	X
Clean the inside of the wire guide			X		X	X
Clean the tires			X		X	X
Lubricate the blade transmission shaft		X				
Inspect and adjust the belts			X		X	
Inspect and tighten bolts and nuts			X		X	

### 4.1 Belt adjustment

The *Perimeter Wire Machine 600MH-Li™* is equipped with three (3) belts. These should be inspected and/or adjusted twenty five (25) hours of use. In some cases, they should be replaced. The main reasons for replacing a worn belt are: cracking, loss of material, unraveling, uneven wear or areas shiny due to heat or slippage.

**NOTE:** Do not overtighten the belts! The belt should move about 1cm when pressure is applied in the middle of the span.

#### 4.1.1 Adjusting the engine belt

- Loosen the 8 bolts without removing them (Figure 1, 2);
- Using your hand, apply pressure to the engine mount until the belt is tight (Figure 3);
- Tighten the 8 bolts.

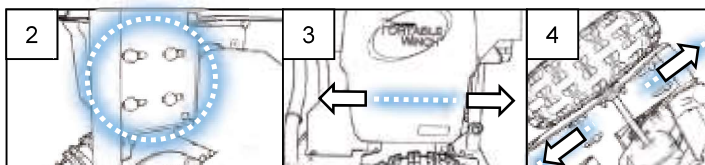
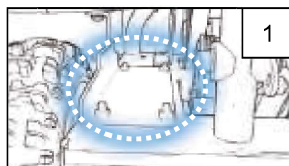

#### 4.1.2 Adjusting the blade transmission belt

EN

- Loosen the 6 bolts (see Figure);
- Move the blade transmission to achieve the desired tension;
- Re-tighten the 6 bolts.  
Maximum torque:  
10 N-m (90 in-lb).

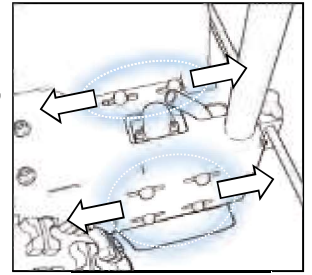

#### 4.1.3 Adjusting the wheels transmission belt

- Loosen the nut with a 13 mm wrench;
- Pivot the transmission on its axis to achieve the desired tension;
- Tighten the nut.

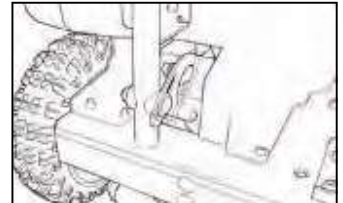

#### 4.1.4 Lubricating the blade transmission shaft (10 hours)

Due to the vertical position of the shaft, some grease is likely to escape during normal use. A small amount of grease should be added to the transmission cap in order to deliver additional grease to the shaft. Follow instructions included with the grease bottle (PWMA-0009) supplied with your PWM600MH-Li. One bottle will last for about 10 refills. Available as a spare part.

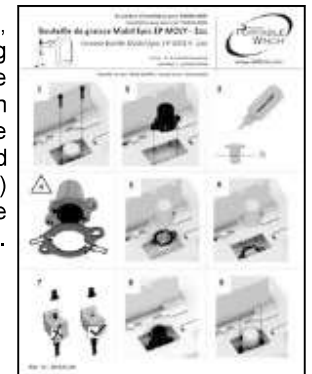

**ATTENTION** ONLY USE LUBRICANT PWMA-0009.

### 4.2 Storage

Always store the *Perimeter Wire Machine 600MH-Li™* on its tires.

### 4.3 Charger and battery (Sold separately).

#### 4.3.1 Charger

**PRECAUTION** THE BATTERY IS NOT FULLY CHARGED. IT IS RECOMMENDED TO CHARGE THE BATTERY FULLY BEFORE THE FIRST USE TO ACHIEVE MAXIMUM OPERATING TIME. THIS LITHIUM-ION BATTERY HAS NO MEMORY AND CAN BE CHARGED AT YOUR DISCRETION.

##### 4.3.1.1 Charging

If the battery has been stored with little charge or with no charge for a long period, the charger enters restart mode which takes 20 hours for the battery to be fully charged. This prolongs the life of the battery. Once fully charged, standard charging is available next time. Any discharged battery requires a cooling period which is mentioned in the battery user manual.

- Plug the charger into the mains.
- Insert the battery into the charger.



This is a diagnostic charger. The LED will flash in a specific order to indicate the battery's current status. (See figure).

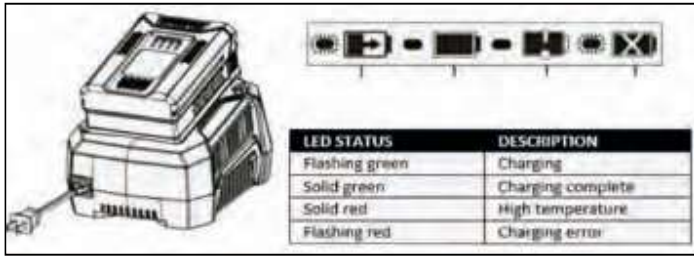

Never leave the battery on the charger once it is fully charged and ready to use.

#### 4.3.1.2 **Fault indication**

When the battery is inserted in the charger and the LEDs flash red, remove the battery from the charger for a minute and then insert again.

- If the LEDs flash green, this means that the battery is charging normally.
- If the LEDs still flash red, remove the battery and unplug the charger again.

Wait a minute, then plug the charger in again and reinsert the battery. If the LEDs flash green, this means that the battery is charging normally.

- If the LEDs flash red, the battery is defective and must be replaced.

#### 4.3.2 **Battery**

##### 4.3.2.1 **Charge verification**

If the battery does not charge correctly :

- Check the socket using another device. Make sure that power is reaching the socket.
- Check that the contacts on the charger have not been short-circuited by debris or foreign objects.

**ATTENTION** IF THE AMBIENT TEMPERATURE IS UNUSUAL, MOVE THE CHARGER AND THE BATTERY TO SOMEWHERE WHERE THE TEMPERATURE IS BETWEEN 7° AND 40 °C (45 AND 104 °F).

**PRECAUTION** IF THE BATTERY IS INSERTED IN THE CHARGER WHEN IT IS WARM OR HOT, THE RED LEDS MAY COME ON. IF THIS HAPPENS, ALLOW THE BATTERY TO COOL AWAY FROM THE CHARGER. THE BATTERY MAY BE CHARGED NORMALLY ONCE A NORMAL CHARGING TEMPERATURE IS ACHIEVED.



REFER TO THE CHARGER AND BATTERY MANUAL FOR MORE INFORMATION.

##### 4.3.3 **Storage**

Storing the battery for more than 30 days:

- Remove the battery from the device.
- Storage the device in a location where the temperature is between 7 °C et 40 °C (45 and 104 °F).

#### 4.4 **Motor**

1 kW DC brushless electric motor.

## 5. **Additional information**

EN

### 5.1 **Error codes**

Error codes are generated to identify the cause of the stoppage - the LEDs flash repeatedly. Here are the most common codes:

Descriptions	LED code	Definitions
Battery connection issue	3	No communication between the battery and the control card. Or loss of communication during the current phase.
Surge protection	4	The current process exceeds the maximum admissible load.
Low-voltage protection	5	The battery charge is minimum (Recharge the battery).

### 5.2 **Disposing of the battery**



The device's battery contains lithium-ion which is a toxic substance.

**ATTENTION** ALL TOXIC MATERIALS MUST BE DISPOSED OF IN ACCORDANCE WITH DIRECTIVES TO AVOID CONTAMINATING THE ENVIRONMENT. BEFORE DISPOSING OF A DAMAGED OR END-OF-LIFE LITHIUM-ION BATTERY, CONTACT YOUR LOCAL WASTE DISPOSAL FACILITY FOR MORE INFORMATION AND THE APPROPRIATE GUIDELINES. TAKE THE BATTERIES TO THE LOCAL RECYCLING AND LANDFILL CENTER AUTHORIZED TO DISPOSE OF LITHIUM-ION BATTERIES. IF THE BATTERY IS CRACKED, EVEN IN THE ABSENCE OF A LEAK. YOU MUST NOT CHARGE OR USE IT. YOU SHOULD REMOVE IT AND REPLACE IT WITH A NEW BATTERY. **DO NOT TRY TO REPAIR IT!**

This avoids injuries and risks of fire, explosion or electric shock or contaminating the environment:

- Cover the battery's terminals using resistant adhesive tape.
- Never try to remove or destroy any battery component.
- Do NOT open the battery.
- Should a leak occur, the electrolyte substances released are corrosive and toxic.
- AVOID this solution coming into contact with your eyes or skin and do not swallow it.
- AVOID disposing of this type of battery with your household waste.
- AVOID burning them.
- AVOID taking them to a landfill site or any municipal solid waste facilities.
- Take them to an approved recycling or landfill center.

### 5.3 **Spare parts**

Spare parts are available from your distributor or by contacting us directly. Please refer to the exploded view in the APPENDIX at the end of this manual to identify the part numbers.

## 5.4 Warranty

The *Perimeter Wire Machine 600MH-Li™* by PortableWinchCo. is guaranteed against all manufacturing defects when owned by the "original owner" as defined below.

The "original owner" is defined as the person or entity which purchased the machine from an authorized dealer as shown by the original invoice.

The warranty is transferable if the new buyer holds a copy of the original invoice. This warranty does not apply to items sold "as is".

The *Perimeter Wire Machine 600MH-Li™* by *Portable Winch Co.* is covered by:

- 1 year warranty (serviced by *Portable Winch Co.* or retailers).

*Portable Winch Co.* will repair or replace defective parts without charge for parts or labour if the part fails due to a defect in materials or workmanship during the warranty period.

- Parts not covered under this warranty:

Parts normally maintained by the customer and that wear with normal and regular use include belts, blade, wire guide, wire guide and blade connector, springs, cables and all other parts defined as those coming into contact with the ground or the wire.

## 5.5 Technical data

- 1 kW DC brushless electric motor
- Steel frame
- Protection class: IPX3 (protection against rainwater)
- Self-propelling transmission
- Weight (without battery): 31.5 kg
- Dimensions (overall): 118 cm x 57 cm x 130 cm
- Maximum speed of wire burial: 15 meters per minute
- Operating temperature -14 to 45°C (7 to 113°F)

## 5.6 Vibration level

The vibration level measured is **11.81 m/s<sup>2</sup>**

## 5.7 Manufacturer

The *Perimeter Wire Machine 600MH-Li™* is manufactured by:

### **Portable Winch Co.**

1170, Thomas-Tremblay st.  
Sherbrooke, Québec, J1G 5G5 CANADA  
Telephone : +1 819 563-2193  
Toll Free (Canada & USA): 1-888-388-7855  
Fax : +1 514 227-5196  
E-mail : info@portablewinch.com  
Website: [www.600mh.info](http://www.600mh.info)

**THE ORIGINAL LANGUAGE OF THIS  
DOCUMENT IS FRENCH**

## 5.8 CE Declaration of Conformity

EN



### DECLARATION OF CONFORMITY

WE LOCATED AT:

**PORTABLE WINCH CO.**  
1170, Thomas-Tremblay st.  
Sherbrooke, QC J1G 5G5  
CANADA  
Tel: +1 819 563-2193  
[www.portablewinch.com](http://www.portablewinch.com)

DECLARE, UNDER OUR SOLE  
RESPONSIBILITY, THAT THE  
PRODUCT:

**PERIMETER WIRE MACHINE**  
Model 600MH-Li  
Serial No 81180001 & more

FOR INTENDED PURPOSE :

Burying a wire to a depth of 4 to 6 cm on soils where grass grows.

Conform to the Machinery Directive 2006/42/EC And also conforms to the disposition of:

-2004/30/UE - Electromagnetic Compatibility Directive.  
-2000/14/CE - Noise Directive.  
-2015/863 - Directive on the restriction of the use of certain hazardous substances in electrical and electronic equipment.

M. Gerold Vonblon,  
Landstrasse 28, A-6714 Nuziders  
is authorized to compile the technical file.

Signed by:

Name: Pierre Roy  
Position: President and Chief Executive

Done at Sherbrooke, QC, Canada  
On April 15th 2019.



**APPENDIX**

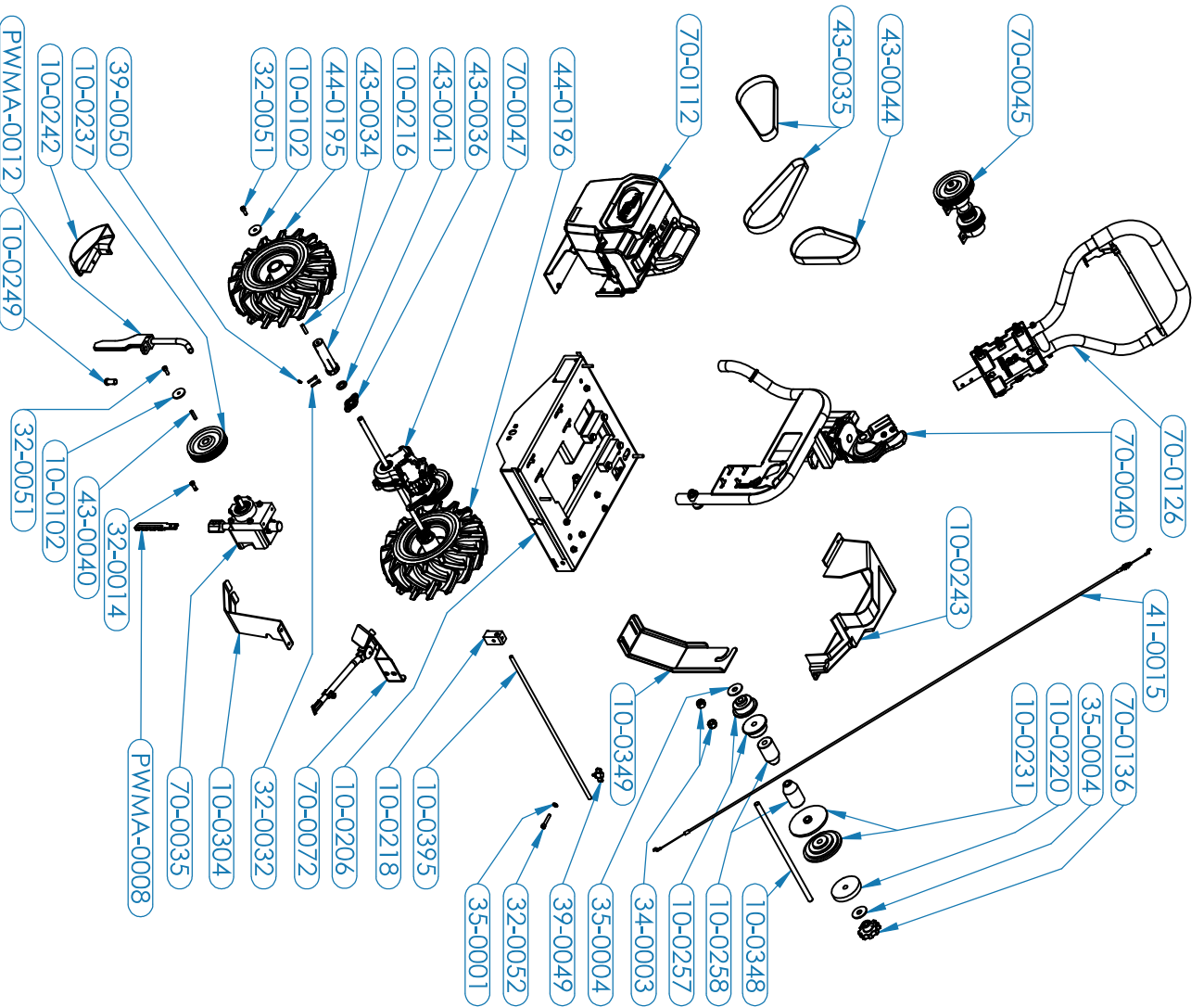

PART No.	DESCRIPTION
10-0102	RETAINING WASHER (1/4" X 1-1/4" OD) - ZN
10-0206	FRAME
10-0216	WHEEL CENTER HUB
10-0218	DISTANCE ROD BLOCK
10-0220	RUBBER DAMPER
10-0231	SPOOL CENTER HUB
10-0237	PULLEY TYPE J 100 MM - SHAFT 15 MM
10-0242	BLADE PULLEY COVER
10-0243	BELT COVER
10-0249	WIRE GUIDE PIN
10-0257	SHORT PLASTIC SPACER
10-0258	LONG PLASTIC SPACER
10-0304	SLIDING FOOT
10-0348	THREADED ROD M12
10-0349	SPOOL SIDE ARM
10-0395	DISTANCE ROD FIBERGLASS 19"
32-0014	REAMER BOLT M6-1.0 X 23 MM
32-0032	SHCS M4-0.7 X 20 MM
32-0051	SHCS M6-1 X 16 MM - ZN
32-0052	SHCS M6-1.0 X 35 MM - ZN
34-0003	NUT M12-1.75 NYLON
35-0001	INTERNAL TOOTH LOCK WASHER 1/4" - ZN
35-0004	FLAT WASHER 1/2" - ZN
39-0049	PLASTIC WING NUT MALE M6-1.0 X 10 MM
39-0050	COILED SPRING PIN 4 MM X 24 MM
41-0015	THROTTLE CABLE ASSY
43-0034	KEY 1/4" X 1/4" X 1"
43-0035	BELT 220-J - 8 GROOVES
43-0036	VERTICAL MOUNT PLASTIC BEARING IGUS EFOM-12
43-0040	KEY 5 MM X 5 MM X 25 MM
43-0041	PLASTIC THRUST WASHER
43-0044	BELT 190-J - 8 GROOVES
44-0195	CHEVRON TIRE ON RIM WITH TUBE 4.10" X 10" RIGHT
44-0196	CHEVRON TIRE ON RIM WITH TUBE 4.10" X 10" LEFT
70-0035	BLADE TRANSMISSION - MACHINED
70-0040	ARCH ASSY
70-0045	INTERMEDIATE SHAFT ASSY
70-0047	WHEEL TRANSMISSION ASSEMBLY
70-0072	KICKSTAND ASSEMBLY
70-0112	MOTOR UNIT 1KW ASSEMBLY
70-0126	MULTI-POSITION ANTI-VIBRATION HANDLE
70-0136	EIGHT LOBE KNOB WITH LOCKING SCREW
PWMA-0008	HEAVY DUTY SOLID CARBIDE BLADE
PWMA-0012	WIRE GUIDE ASSEMBLY - 6 MM



**APPENDIX(70-0040)**

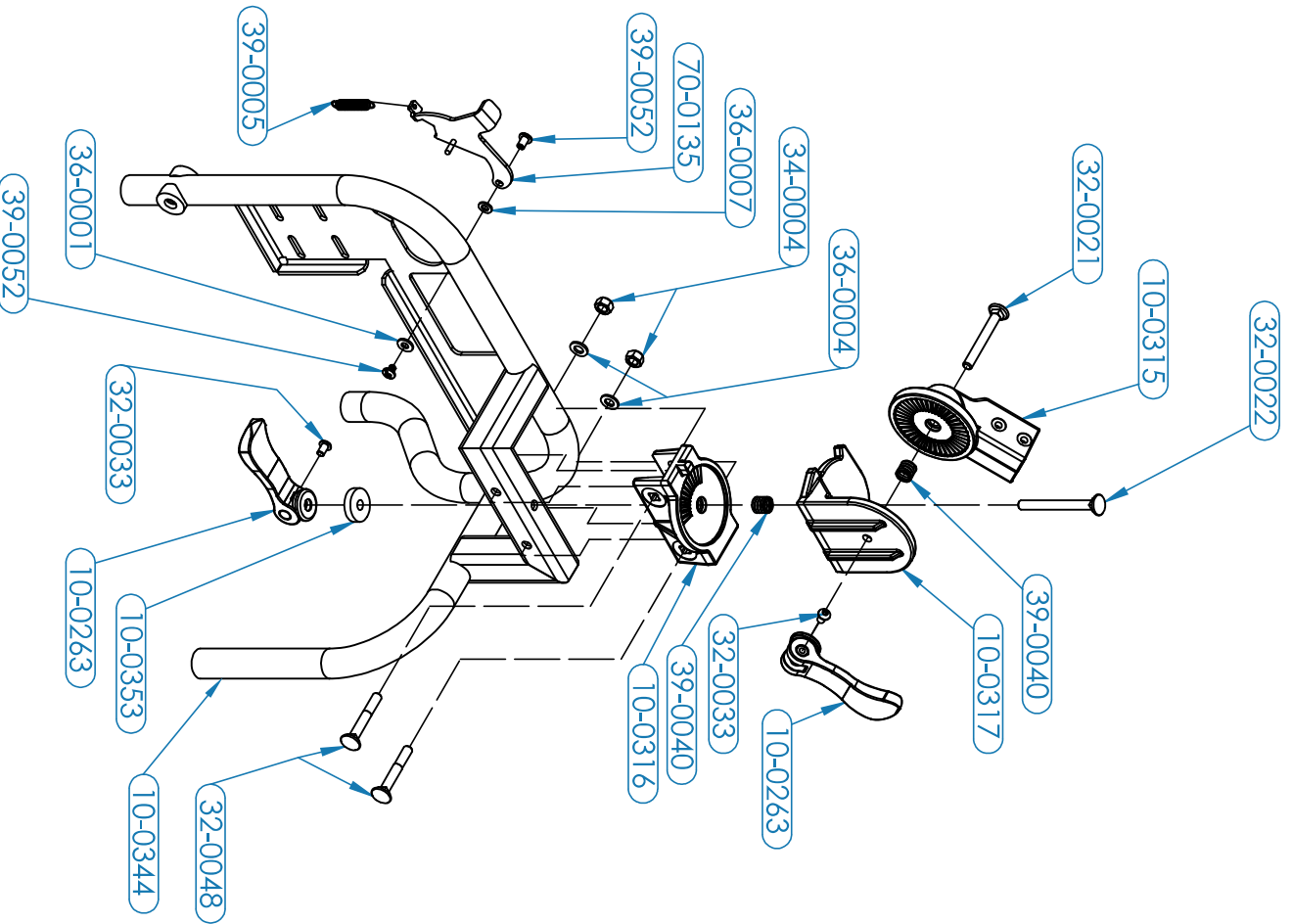

PART No.	DESCRIPTION
10-0263	CAM LEVER
10-0315	HANDLE TOP PIVOT
10-0316	HANDLE BASE PIVOT
10-0317	HANDLE CENTER PIVOT
10-0344	ARCH FRAME
10-0353	RETAINING WASHER (.33 X 1-1/8 OD)
32-0021	CARRIAGE BOLT M8-1.25 X 65 - CLASSE 8.8 - ZN
32-0022	CARRIAGE BOLT M8-1.25 X 80 - ZN
32-0033	BHCS M6-1 x 10mm - BLACK
32-0048	CARRIAGE BOLT M8-1.25 X 55 - ZN
34-0004	NUT M8-1.25 NYLON - ZN
36-0001	FLAT WASHER M6 - ZN
36-0004	FLAT WASHER M8 - ZN
36-0007	NYLON PLASTIC WASHER M6
39-0005	EXTENSION SPRING DWX-03 OD - 8.5 - SS
39-0040	COMPRESSION SPRING 0.480" X 0.500" X 0.067"
39-0052	STEEL BINDING BARREL AND SCREW 10-24, 3/8 TO 1/2 - ZN
70-0135	SPOOL HOLDER

**APPENDIX(70-0126)**

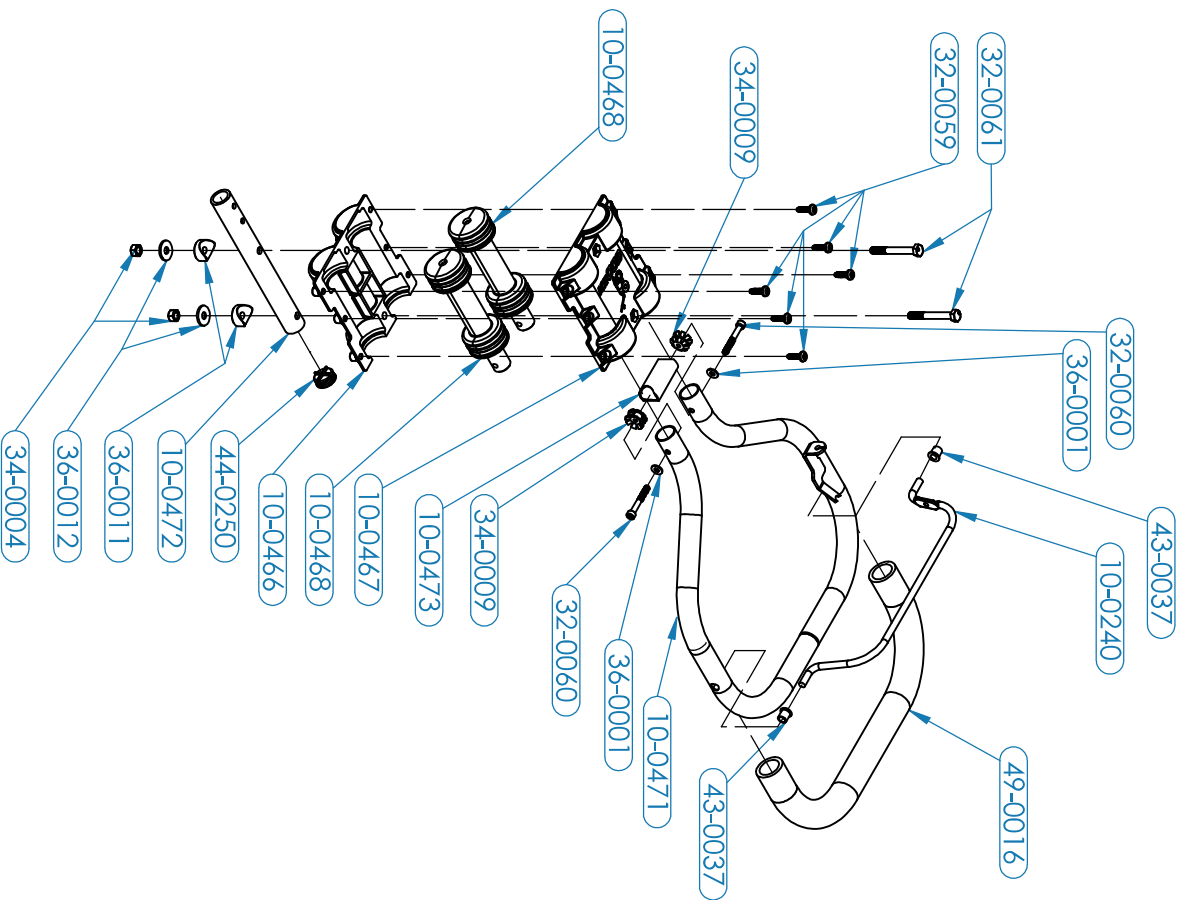

PART No.	DESCRIPTION
10-0240	TRACTION LEVER
10-0466	ANTI-VIBRATION HOUSING BOTTOM
10-0467	ANTI-VIBRATION HOUSING TOP
10-0468	ANTI-VIBRATION RUBBER WITH INNER BAR
10-0471	HANDLE WELDMENT
10-0472	JUNCTION TUBE
10-0473	HANDLE JONCTION SPACER
32-0059	TAPTITE 2000 SP MR6-1.0 X 20mm TORX DRIVE - ZN
32-0060	SHCS M6-1.0 X 45mm - ZN
32-0061	HEX CAP SCREW M8-1.25 X 65mm - ZN
34-0004	NUT M8-1.25 NYLON - ZN
34-0009	CROWN NUT M6-1.0/21.4
36-0001	FLAT WASHER M6 - ZN
36-0011	SADDLE WASHER FOR TUBE 1" - HOLE 0.325" - ZN
36-0012	FLAT WASHER M8 OVERSIZE - ZN
43-0037	PLASTIC FLANGED BUSHING ID:5/16 X OD:7/16 X 1/2
44-0250	CAP FOR ROUND TUBE 1 OD WALL 0.134-0.083
49-0016	EPDM FOAM GRIP 1" x 20"



THE ORIGINAL  
**PORTABLE  
WINCH™**

[www.600mh.info](http://www.600mh.info)

[\*\*info@portablewinch.com\*\*](mailto:info@portablewinch.com)

**1 888 388-7855 / +1 819-563-2193**