

WICHTIG:
Vor Gebrauch
lesen

IMPORTANT:
Read before
using

IMPORTANTE:
Lea antes de
usar

IMPORTANT:
Lire avant
usage

IMPORTANT:
leggere prima
dell'uso

BELANGRIJK:
lees voor
gebruik

VIKTIG:
Les før du
bruker

VIKTIG:
Läs innan du
använder

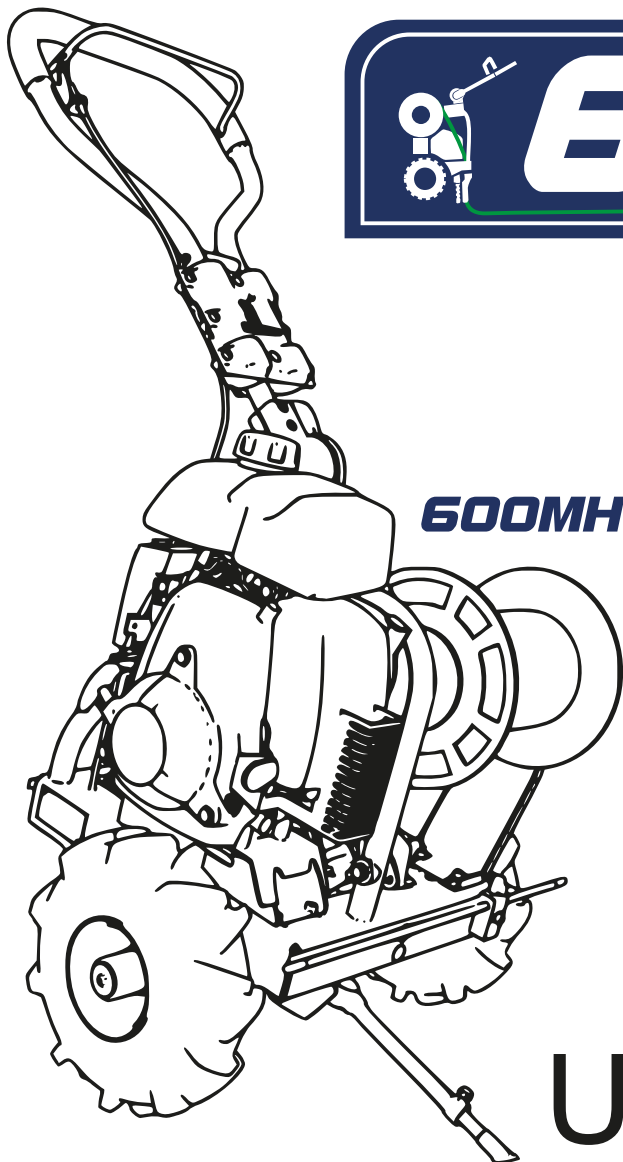

CABLE LAYING MACHINE
MACHINE À FILS
KABELVERLEGUNGSMASCHINE

600MH

POWERED by
HONDA™

USER GUIDE



DE
EN
ES
FR
IT
NL
NO
SV



Betriebs-/Sicherheitshinweise
Operating/safety Instructions
Instrucciones de operación / seguridad
Consignes de fonctionnement/sécurité
Istruzioni per l'uso e la sicurezza
Gebruiksaanwijzing / Veiligheidsvoorschriften
Bruksanvisning / sikkerhet
Bruksanvisning / säkerhet

www.600mh.info

WICHTIG:
Vor Gebrauch
lesen

IMPORTANT:
Read before
using

IMPORTANTE:
Lea antes de
usar

IMPORTANT:
Lire avant
usage

IMPORTANT:
leggere prima
dell'uso

BELANGRIJK:
lees voor
gebruik

VIKTIG:
Les før du
bruker

VIKTIG:
Läs innan du
använder

INTRODUCTION

Portable Winch Co. wishes to thank you for purchasing a Perimeter Wire Machine 600MH™. This manual was written to help you make the best use of your new machine and to use it in the most secure way.

PLEASE READ CAREFULLY BEFORE USE

For any problems or questions, please contact an authorized Portable Winch Co. dealer or contact us directly.

1 Safety guidelines

The Perimeter Wire Machine 600MH™ is designed to bury electrical wires up to 6 mm in diameter at a depth of between 4 and 6 cm in grassy soil. The use of this machine implies serious risks of injury, property damage or even death. **Do not underestimate its potential danger.**

1.1 Safety messages

Your safety and the safety of others are very important. You will find important safety messages in this manual. **Please read them carefully.**

These security messages warn you of potential injuries to either yourself or others. Each safety message is preceded by a warning symbol.

SYMBOLE	SIGNIFICATION
	YOU WILL BE FATALLY OR SERIOUSLY INJURED IF YOU DO NOT FOLLOW THESE INSTRUCTIONS.
	YOU COULD BE FATALLY OR SERIOUSLY INJURED IF YOU DO NOT FOLLOW THESE INSTRUCTIONS.
	YOU COULD BE INJURED IF YOU DO NOT FOLLOW THESE INSTRUCTIONS.
	READ THE USER GUIDE.
	EYE AND HEARING PROTECTION.
	WEAR GLOVES.

1.2 Label

1.2.1 Serial number label

The serial number label can be found on the right rear of the machine. In addition to the serial number, the fundamental specifications of your model are also found there.

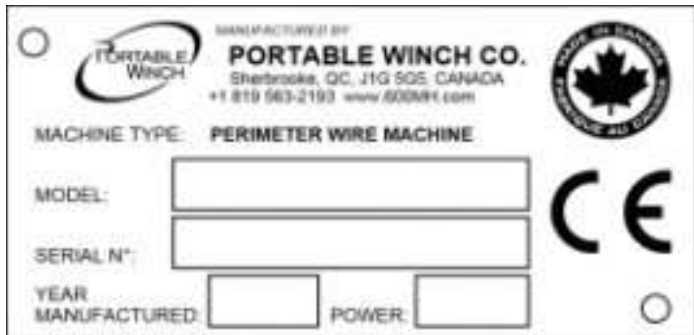

1.2.2 Personal protection equipment label



The label indicates that it is highly recommended to wear the following:
 • Safety glasses with defectors • Hearing protection;
 • Anti-vibration gloves • Steel toe-capped shoes.

1.2.3 Read the user manual label

The read the user manual label indicates that it is necessary to read the entirety of this manual before using the machine.



1.2.4 Warning label for potential dangers of the blade



This warning label informs you of the following potential dangers:

- Debris can fly out and cause injuries to the eyes;
- The blade can crush feet;
- The blade can crush hands;
- The blade can cut hands.

1.2.5 Warning label for slope usage



The warning label for slope usage indicates that the machine must not be used on slopes steeper than 50%.

1.2.6 Safety information

- DANGER** BEFORE STARTING ANY PERIMETER WIRE LAYING WORK, MAKE SURE YOU KNOW THE LOCATIONS OF ANY ELECTRICAL WIRES OR WATER PIPES IN THE WORK ZONE.
- ATTENTION** THE MACHINE WEIGHS 36 KG. BE CAREFUL WHEN TRYING TO LIFT IT. IT IS HIGHLY RECOMMENDED TO LIFT IT WITH A SECOND PERSON.
- ATTENTION** NEVER LET AN UNTRAINED PERSON USE THE MACHINE. MAKE SURE THAT THEY ARE AWARE OF THE SAFETY AND USAGE INSTRUCTIONS AND HAVE READ THIS MANUAL.
- PRECAUTION** ONLY RESPONSIBLE ADULTS WHO HAVE READ THESE INSTRUCTIONS ARE AUTHORISED TO OPERATE THE MACHINE. DO NOT ALLOW CHILDREN TO OPERATE IT.
- PRECAUTION** KEEP CHILDREN, SPECTATORS AND ANIMALS OUTSIDE OF THE WORK ZONE. STOP THE MACHINE IN SOMEONE ENTERS THE WORK ZONE.
- ATTENTION** DO NOT PLACE YOUR FEET NEAR THE BLADE WHILE THE ENGINE IS RUNNING.
- ATTENTION** ENSURE THAT YOUR CLOTHING CANNOT GET CAUGHT IN THE MOVING PARTS OF THE MACHINE.
- PRECAUTION** CLEAN AND/OR REPLACE ALL SECURITY LABELS THAT ARE DIRTY, DETERIORATED, UNREADABLE OR TORN.

- PRECAUTION** ALWAYS WEAR SAFETY GLASSES WITH DEFLECTORS WHEN USING THE MACHINE.
- PRECAUTION** ALWAYS WEAR GLOVES WHEN USING THE MACHINE.
- PRECAUTION** ALWAYS WEAR HEARING PROTECTION WHEN USING THE MACHINE.
- PRECAUTION** ALWAYS WEAR STEEL TOE-CAPPED SHOES WHEN USING THE MACHINE.
- PRECAUTION** DO NOT BACK UP THE MACHINE UNLESS ABSOLUTELY NECESSARY. ALWAYS CHECK THE GROUND AND BEHIND YOU BEFORE MOVING.
- PRECAUTION** CLEAR THE WORK ZONE OF OBJECTS SUCH AS SMALL STONES, TOYS, METAL WIRES, STICKS, ETC. THEY CAN BE CUT AND/OR LIFTED AND PROJECTED BY THE BLADE.
- PRECAUTION** NEVER USE THE MACHINE IF THE PROTECTION GUARDS AND OTHER SAFETY DEVICES ARE NOT IN PLACE.
- PRECAUTION** STOP THE ENGINE WHEN CROSSING DRIVEWAYS, SIDEWALKS OR STREETS.
- DANGER** DO NOT USE THE MACHINE IF YOU ARE UNDER THE INFLUENCE OF ALCOHOL OR DRUGS.
- DANGER** NEVER USE THE MACHINE ON WET GRASS. WALK AT A STEADY PACE, HOLD ON TO THE HANDLE AND WALK NEVER RUN.
- PRECAUTION** IF THE MACHINE STARTS TO VIBRATE ABNORMALLY, STOP THE ENGINE AND CHECK IMMEDIATELY FOR THE CAUSE. STRONG VIBRATIONS ARE USUALLY A SIGN SOMETHING IS WRONG
- DANGER** STOP THE ENGINE BEFORE CLEANING, INSPECTION OR REPAIRS.
- PRECAUTION** BOLTS AND NUTS, ESPECIALLY THE BOLTS USED TO ATTACH THE BLADE SHOULD ALWAYS BE PROPERLY TIGHTENED. KEEP THE MACHINE IN GOOD CONDITION.
- DANGER** NEVER TAMPER WITH SAFETY DEVICES. REGULARLY CHECK THEY ARE WORKING PROPERLY.
- PRECAUTION** KEEP GRASS, LEAVES OR DEBRIS OF ANY KIND FROM ACCUMULATING ON THE MACHINE OR IN FRONT OF THE BLADE. CLEAN OIL OR FUEL SPILLAGES.
- PRECAUTION** ALLOW THE MACHINE TO COOL BEFORE STORING IT.
- PRECAUTION** IF YOU HIT AN OBJECT, STOP THE MACHINE AND CHECK FOR DAMAGE. BEFORE RESTARTING, REPAIR THE DAMAGE IF NECESSARY.
- PRECAUTION** THE MACHINE'S BLADE CAN CUT. WRAP THE BLADE OR WEAR GLOVES AND BE CAREFUL WHEN PERFORMING MAINTENANCE ON THE BLADE.

2. Checks before use

2.1 When receiving

Inspect the box to detect any obvious damage. If a part is missing or damaged, notify the carrier immediately. Please refer to the assembly manual for the contents of your machine.

2.2 Assembly and start-up

2.2.1 Assembly

The Perimeter Wire Machine 600MH™ was completely assembled at the factory except for the following parts: blade, wire guide, sliding foot, blade pulley cover, wheels and handle. To ensure safe and appropriate operation, these parts must be attached securely. Use the **appropriate wrench** to ensure they are tightened sufficiently. To assemble the components mentioned above, **please follow the instructions in the 600MH ASSEMBLY MANUAL**.

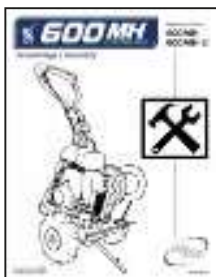

IT IS ESSENTIAL THAT ALL OF THE STEPS ARE CARRIED OUT



2.2.2 Start-up – Preparation and start-up of the engine

Perimeter wire machine 600MH™ is equipped with a four-stroke GXH-50cc Honda engine.

2.2.2.1 Engine Oil

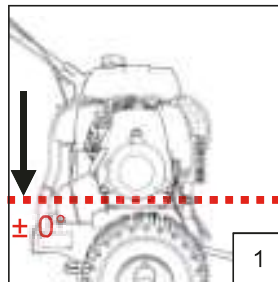

Fill the Honda engine with a maximum of 0.25 liters of SAE 10W-30 API SJ oil. For special uses and in extreme temperature conditions, consult the Honda engine manual.

Follow these instructions to make sure that the engine receives the correct quantity of oil.

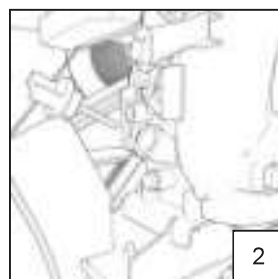

1. Position the machine so that the engine is level (Figure 1);
2. Fill the crankcase (Figure 2);
3. Check the oil level. It should be up to the edge of the opening when the engine is level (Figure 2).

2.2.2.2 Gasoline(petrol)

IMPORTANT: Fill the tank with the machine resting on the support foot to avoid overfilling.

Fill the tank with **UNLEADED** gasoline. Do not use an oil/gasoline mixture. This machine is equipped with a four-stroke engine. Consult the Honda engine manual for more information.

2.2.2.3 First use

Consult the Honda engine manual for starting instructions. The on/off switch is located on the engine.

Take care to pull the starter grip in the output axis of the rope. If it is pulled vertically, the friction of the rope on the plastic housing may damage the rope and/or the housing (see Figures).

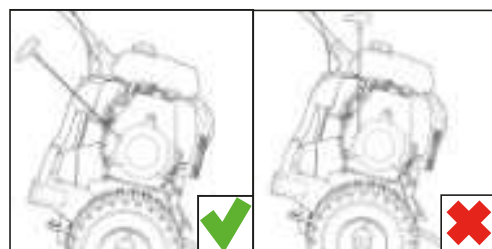

IMPORTANT: Let the engine idle for five (5) minutes.

2.2.3 Oil level warning system (Oil Alert™)

The Honda engine GXH-50 is equipped with the Oil Alert™ system that automatically cuts the ignition when the oil level in the crankcase falls below a safe level. The Oil Alert™ system also stops the engine when the engine's operating angle exceeds 20 degrees (± 4 degrees).

Check the oil level before each use. Add oil if necessary.

2.2.4 Stopping the engine

To stop the engine:

- 1) Release the traction lever if the machine is in motion;
- 2) Lower the throttle lever to idle position;
- 3) Turn the switch to the OFF position.

IMPORTANT: If the on/off switch fails, close the choke to stop the engine.

If you do not intend to start the engine soon and if you need to move the machine, wait until the blade and all moving parts have stopped and turn the fuel valve to the OFF position.

3. Usage

PRECAUTION ITS COMPACT SIZE AND LOW WEIGHT ALLOW THE 600MH™ PERIMETER WIRE MACHINE TO BE EASILY CARRIED IN A SMALL VEHICLE. IT IS STRONGLY RECOMMENDED THAT YOU TURN THE FUEL VALVE TO THE OFF POSITION (OFF).

Before each use:

- Check the soil consistency and the deepest possible insertion depth.
- Check the engine oil level.
- Check the blade attachment.
- Check the attachment of the wire guide.
- Check the tire pressure.

3.1 Installing the perimeter wire spool

The 600MH™ Perimeter Wire Machine is designed to accommodate most wire spools provided by the manufacturers and third party resellers of robot lawnmowers.

IMPORTANT: Six stepped spacers are supplied for accommodating spools of different width and center diameters. Select the spacers that will allow for easy insertion of the rod and spool assembly with the most direct path to the wire guide located behind the blade.

3.1.1 Spools mounted on a drum

The hardware provided is suitable for installation of most models up to 800 metres (according to wire diameter):

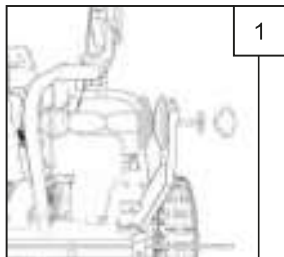

- 1) Unscrew the clamping handle and remove with the flat washer.



- 2) Lift the shaft while opening the blocker.

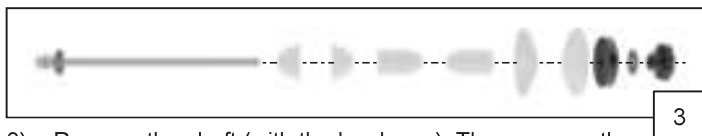

- 3) Remove the shaft (with the hardware). Then remove the hardware.

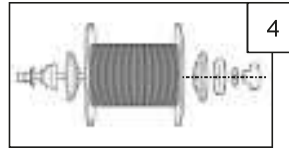

- 4) Insert in the desired order depending on the spool used.

NOTE: Make sure the wire is dispensed from the top of the reel.

- a. Spacer(s);
- b. The left centering hub (towards the inside of the spool);
- c. The spool (support at the right level depending on its diameter on the hub);
- d. The right centering hub (towards the inside of the spool);
- e. Spacer(s);
- f. The rubber washer;

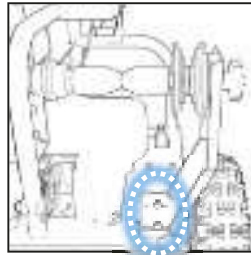

NOTE : The spool holding arm may need to be adjusted to fit the spool and to avoid unnecessary turning of the handle when setting the reel tension.

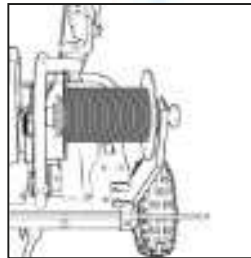

- 5) Insert the shaft by sliding it into the slots provided (arch and adjustable spool support). Return the flat washer and the clamping handle to the shaft. Turn the clamping handle until there is sufficient tension to prevent the spool from free wheeling.

NOTE: When the adequate reel tension is set, you can tighten the handle's jam bolt slightly to keep it in position. Do not overtighten to prevent damaging the threads on the rod.

3.1.2 Spools without a drum

3.1.2.1 Spools that empty through the center

Some manufacturers supply a spool designed to be emptied through the center. Two (2) PERIMETER WIRE BOXES **18 cm x 18 cm (part PWMA-0002)** and **22.5 cm x 22.5 cm (part PWMA-0003)**, available as optional accessories for the Perimeter Wire Machine 600MH™, accepting this type of spool (up to 17.5 cm or 21 cm in diameter, depending on the box used).

3.1.2.2 Spools with no defined shape

Some manufacturers provide wire designed to be wound around the drum manually. As an optional accessory for the Perimeter Wire Machine 600MH™, a **PERIMETER WIRE DRUM (part PWMA-0001)** is available to allow the winding of the wire provided by the manufacturer.

3.2 Moving the machine to the work zone

To move the machine to the work zone:

- 1) Loosen the clamping lever on the handle;
- 2) Pivot the handle until it is vertical on the machine.
- 3) Lift the support foot in front the machine.
- 4) Pull or push the machine to the work area.

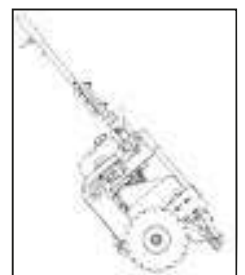

3.3 Using the distance guide

The Perimeter Wire Machine 600MH™ is equipped with an adjustable distance guide. This is used to align the machine with the edge of the course and bury the wire at a distance between 15 cm and 45 cm.

In addition, the distance guide can be placed at the front or back of the machine, depending on user preference.

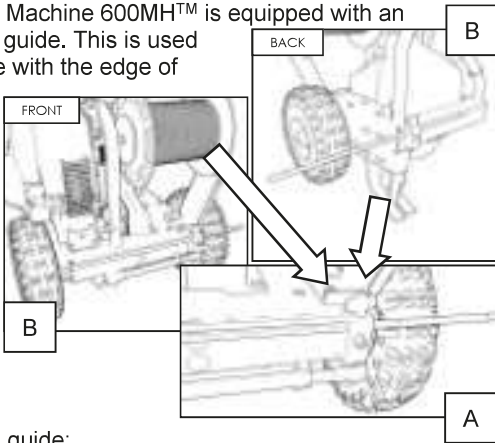

To use the distance guide:

- 1) Unscrew the wing nut (See A);
- 2) Position the distance guide at the desired distance according to the ruler label (on the front or back of the machine). The ruler ensures positioning between 15 and 45 cm to the nearest centimeter. (See B);
- 3) Tighten the wing nut.



3.4 Self-propulsion

The Perimeter Wire Machine 600MH™ is equipped with a transmission for selfpropulsion. This allows for a constant rate of installation and considerably reduces operator effort.

3.5 Inserting the perimeter wire in the wire guide

Proceed as follows:

- 1) Pull the end of the wire from the spool;
- 2) Insert the wire in the guide wire tube;
- 3) Push the wire until it emerges;

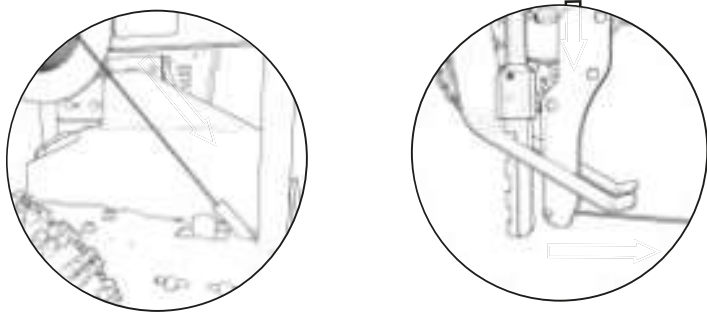

3.6 Burying the perimeter wire in the ground

Refer to the manufacturer's instructions of the robot mower for the technical specifications for installing perimeter wire.

Initially, attach the end of the wire to a stake or a tool planted in the ground.

- 1) Start the engine;
- 2) Lift the support foot at the front of the machine;
- 3) Slowly insert the blade into the ground by pressing down on the handle until the frame is parallel to the ground (Figure 1);

- 4) Apply pressure to the traction handle to move the machine (Figure 2)..

EN

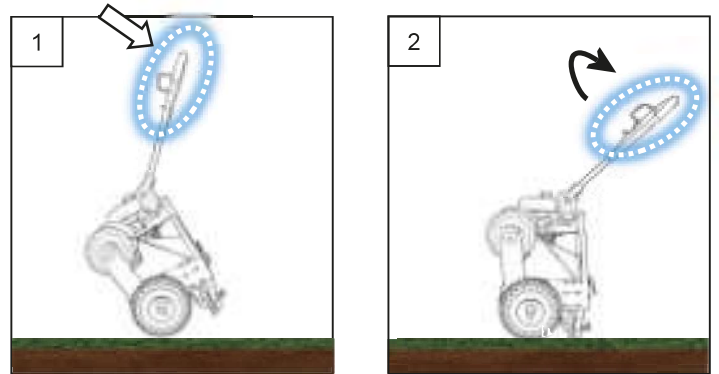

3.7 Adjusting the handle height

It is important to adjust the handle height before working with the Perimeter Wire Machine 600MH™.

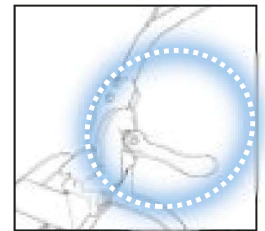
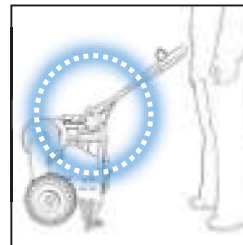

The recommended handle position is at the waist level, but adjust it to your preferred height using the handle clamping lever.

3.8 Overcoming obstacles in the ground

When burying the wire in the ground, some immovable obstacles such as large rocks or roots will be encountered. To avoid damage to the blade and/or the machine, follow the instructions below:



ATTENTION DO NOT PUSH THE BLADE AGAINST THE OBSTACLE IN AN ATTEMPT TO TRY TO CUT OR DISPLACE IT.

- 1) Release the traction handle (Figure 1);
- 2) Push the handle upwards, trying to keep the blade and the wire guide in the soil (Figure 2, A);
- 3) Lightly press on the traction handle to pass over the obstacle (Figure 2, B);
- 4) Lower the machine so that the frame is parallel to the ground (Figure 3, A);
- 5) Resume the job by pressing the traction handle (Figure 3, B).

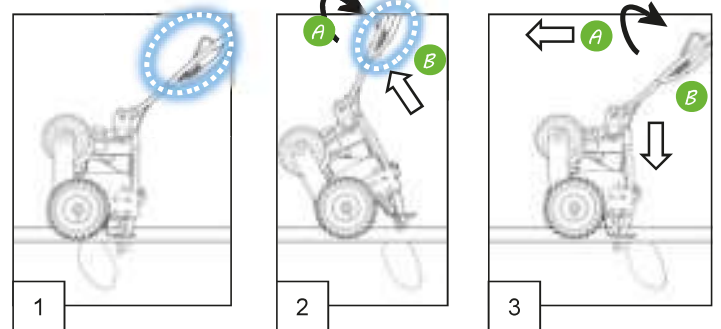

3.9 Insertion of perimeter wire in a tight corner

When designing the Perimeter Wire Machine 600MH™, every feature has been implemented to allow burying of the wire as close as possible to the perimeter of the field and to avoid having to

manually bury the wire. Its compact size and the 15 cm blade offset from the outside of the wheel are good examples. The handle is also designed to quickly and easily pivot as needed to turn tight corners.

Follow the steps below:

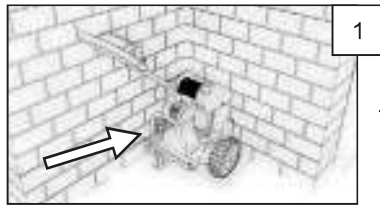

- 1) Move as far as possible into the corner (See distance recommended by the manufacturer);

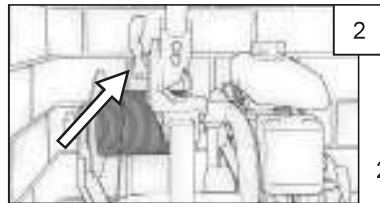

- 2) Loosen the clamping lever on the handle;

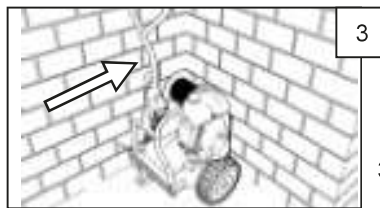

- 3) Lift the handle until vertical;

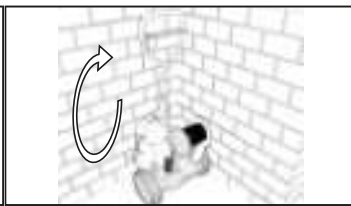
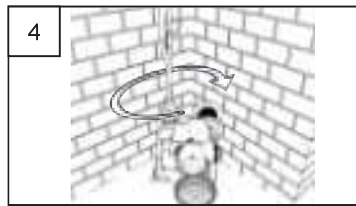

- 4) Turn the machine in the desired direction by grasping the arch;

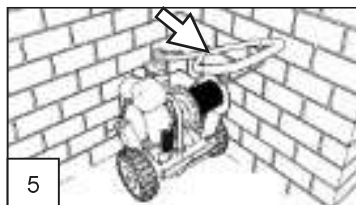

- 5) Lower the handle until horizontal;

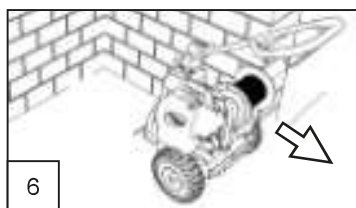

- 6) Place your left hand on the arch and your other hand on the lever, to move the machine to free from the corner and to able to resume the normal working position (press on the traction handle to move);

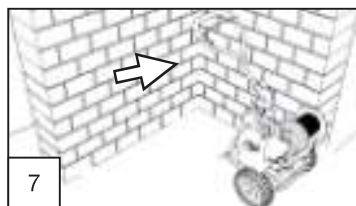

- 7) Once out of the corner, move the handle to the desired position to continue burying the wire.

3.10 Transport

The best way to transport the 600MH is to fold the handle forward parallel to the ground. With the foot stand folded, tilt the machine down until the handle is on the floor of the transport vehicle. Secure it with a ratchet strap. Make sure the gas tank valve is turned off.



If transported inside a vehicle, keep in mind that there will be some fuel vapors release thru the gas tank breather cap. Vapors can be stopped by placing a plastic film temporarily between the cap and the gas tank.

4. Maintenance

Some adjustments should be performed periodically to maintain the machine in good working condition. Here is the maintenance schedule:

ACTION	BEFORE / EVERY					AFTER
	Use	10 hours	25 hours	100 hours	Storage	Use
Check the blade attachment	X					
Check the wire guide attachment	X					
Check the tire pressure	X					
Check the oil level	X					
Check the blade	X		X			
Clean the top and bottom of the machine			X		X	X
Clean underneath the guards			X		X	X
Clean the blade attachment system			X		X	X
Clean the inside of the wire guide			X		X	X
Clean the tires			X		X	X
Lubricate the blade transmission shaft		X				
Inspect and adjust the belts			X		X	
Inspect and tighten bolts and nuts			X		X	
Check the engine by the Honda manual			X	X	X	

4.1 Belt adjustment

The Perimeter Wire Machine 600MH™ is equipped with three (3) belts. These should be inspected and/or adjusted every twenty five (25) hours of use. In some cases, they should be replaced. The main reasons for replacing a worn belt are: cracking, loss of material, unraveling, uneven wear or areas shiny due to heat or slippage.

NOTE: Do not overtighten the belts! The belt should move about 1cm when pressure is applied in the middle of the span.

4.1.1 Adjusting the engine belt

- Loosen the 8 bolts without removing them (Figure 1,2);
- Using your hand, apply pressure to the engine mount until the belt is tight (Figure 3);
- Tighten the 8 bolts.

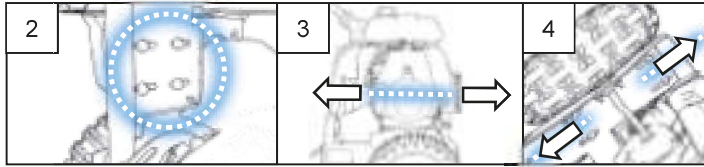

4.1.2 Adjusting the blade transmission belt

- Loosen the 6 bolts (see Figure);
- Move the blade transmission to achieve the desired tension;
- Re-tighten the 6 bolts.
Maximum torque:
10 N-m (90 in-lb).

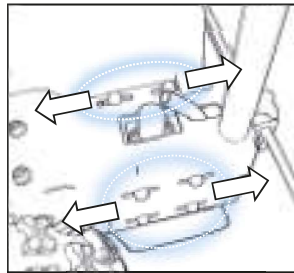

4.1.3 Adjusting the wheels transmission belt

- Loosen the nut with a 13 mm wrench;
- Pivot the transmission on its axis to achieve the desired tension;
- Tighten the nut.

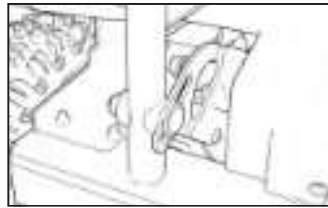

4.1.4 Lubricating the blade transmission shaft (10 hours)

Due to the vertical position of the shaft, some grease is likely to escape during normal use. A small amount of grease should be added to the transmission cap in order to deliver additional grease to the shaft. Follow instructions included with the grease bottle (PWMA-0009) supplied with your 600MH. One bottle will last for about 10 refills. Available as a spare part.

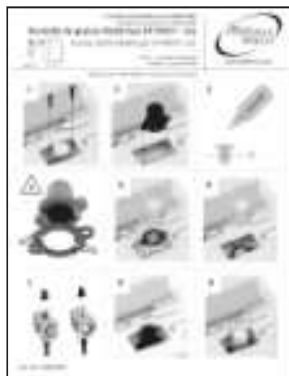

ATTENTION ONLY USE LUBRICANT PWMA-0009.

4.1.5 Storage

Always store the 600MH™ Perimeter Wire Machine on its tires. Please refer to the Honda engine owner's manual for storage instructions.

4.2 Engine

Maintain the engine according to the instructions provided in the Honda engine user manual.

5.0 Additional information

5.1 Spare parts

Spare parts are available from your distributor or by contacting us directly. Please refer to the exploded view in APPENDIX at the end of this manual to identify the part numbers.

5.2 Warranty

The Perimeter Wire Machine 600MH™ by Portable Winch Co. Is guaranteed against all manufacturing defects when owned by the "original owner" as defined below. The "original owner" is defined as the person or entity which purchased the machine from an authorized dealer as shown by the original invoice. The warranty is transferable if the new buyer holds a copy of the original invoice. This warranty does not apply to items sold "as is". The Perimeter Wire Machine 600MH™ by Portable Winch Co. is covered by:

- 1 year warranty (serviced by Portable Winch Co. or retailers);

Portable Winch Co. will repair or replace defective parts without charge for parts or labour if the part fails due to a defect in materials or workmanship during the warranty period.

Parts not covered under this warranty :

Parts normally maintained by the customer and that wear with normal and regular use include belts, blade, wire guide, wire guide and blade connector, springs, cables and all other parts defined as those coming into contact with the ground or the wire.

5.3 Technical data

- Engine: 4-stroke Honda GXH-50cc.
- Steel frame
- Self-propelling transmission
- Weight (dry): 36 kg
- Dimensions (overall): 118 cm X 57 cm X 130 cm
- Maximum speed of wire burial*: 15 meters per minute.

5.4 Sound power levels

Pressure level at the workstation : LpA **85 dB(A)**.

Guaranteed sound power level (LwA)*:

- LwA of **108 dB(A)** with included uncertainty KwA = 2,5 dB.

5.5 Vibration level

The vibration level measured is **11.94 m/s²**

5.6 Manufacture

The Perimeter Wire Machine 600MH™ is manufactured by:
Portable Winch Co.

1170, Thomas-Tremblay st.
Sherbrooke, Québec, J1G 5G5 CANADA
Telephone : +1 819 563-2193
Toll Free (Canada & USA): 1-888-388-7855
Fax : + 1 514 227-5196
E-mail : info@portablewinch.com
Website: www.600mh.info

THE ORIGINAL LANGUAGE OF THIS DOCUMENT IS FRENCH



DECLARATION OF CONFORMITY

WE
LOCATED AT

PORTABLE WINCH CO.
1170, rue Thomas-Tremblay
Sherbrooke, QC J1G 5G5
CANADA
Tel: +1 819 563-2193
www.portablewinch.com

DECLARE, UNDER OUR SOLE
RESPONSIBILITY, THAT THE
PRODUCT:

PERIMETER WIRE MACHINE
Modèle 600MH
N° série 80190001 & more

DESIGNED FOR THIS USE:

Burying a wire to a depth of 4 to 6 cm on soils where the grass grows.

In compliance with the "Machines" directive 2006/42/EC as well as the following directives:

2004/30/EU

Electromagnetic Compatibility Directive.

-2000/14/EC

Directive on Environmental Noise Emissions.

M. Gerold Vonblon,
Landstrasse 28, A-6714 Nuziders
is authorized to compile the technical file.

Signed by:

Name: Pierre Roy
Position: President and Chief Executive

In Sherbrooke, QC, Canada
Friday, 23rd November 2018.



APPENDIX

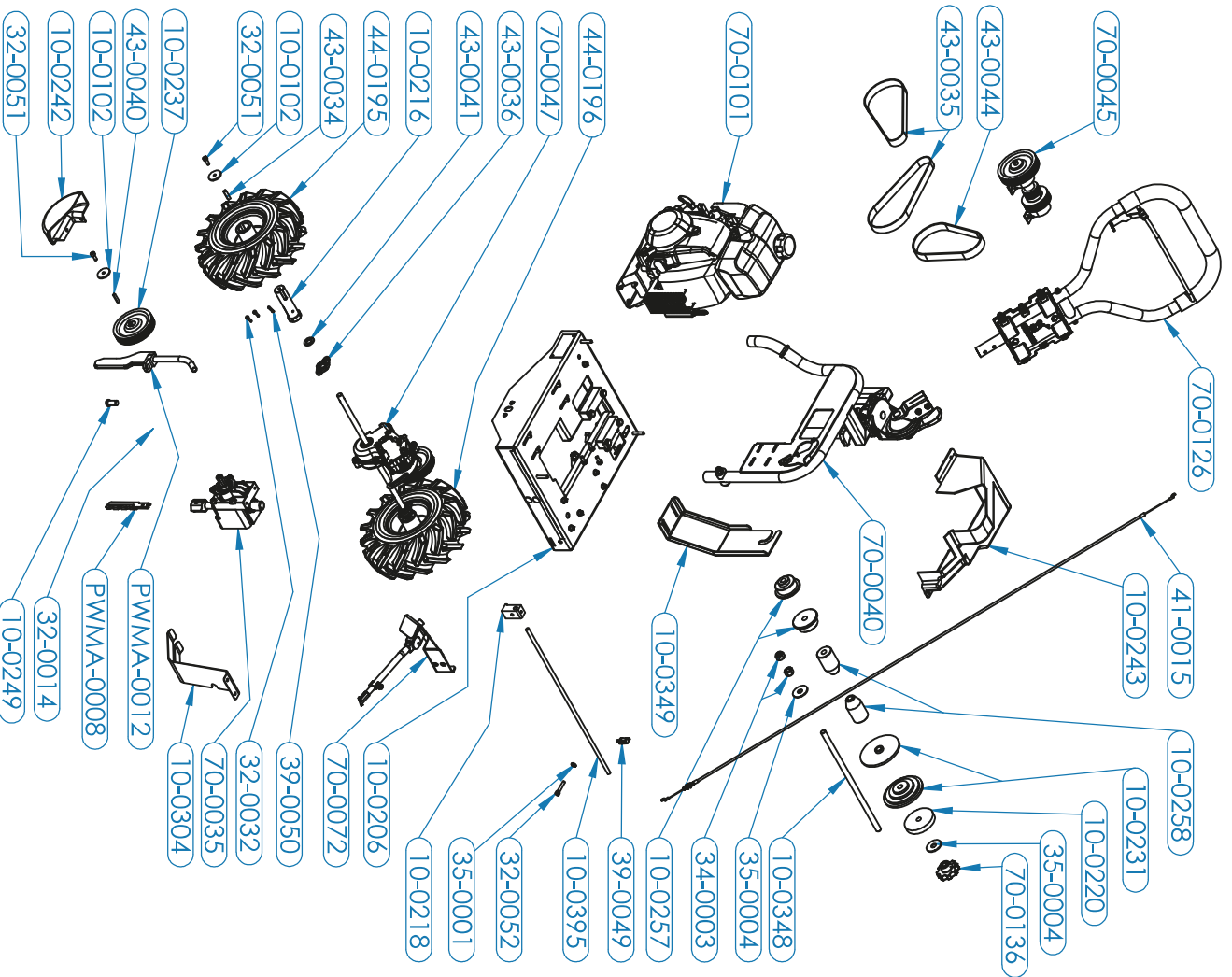

PART No.	DESCRIPTION
10-0102	RETAINING WASHER (1/4 X 1-1/4 OD) - ZN
10-0206	STEEL FRAME
10-0216	WHEEL CENTER HUB
10-0218	DISTANCE ROD BLOCK
10-0220	RUBBER DAMPER
10-0231	SPOOL CENTER HUB
10-0237	PULLEY TYPE J 100 MM - SHAFT 15 MM
10-0242	BLADE PULLEY COVER
10-0243	BELT COVER
10-0249	WIRE GUIDE PIN
10-0257	SHORT PLASTIC SPACER
10-0258	LONG PLASTIC SPACER
10-0304	SLIDING FOOT
10-0348	THREADED ROD M12
10-0349	SPOOL SIDE ARM
10-0395	FIBER GLASS DISTANCE ROD 5/16" X 19"
32-0014	REAMER BOLT M6-1.0 X 23
32-0032	SHCS M4-0.70 X 20 MM
32-0051	SHCS M6-1.0 X 16 MM - ZN
32-0052	SHCS M6-1.0 X 35 - ZN
34-0003	NUT M12-1.75 NYLON - ZN
35-0001	INTERNAL TOOTH LOCK WASHER 1/4 - ZN
35-0004	FLAT WASHER 1/2 - ZN
39-0049	WING SCREW PLASTIC M6-1.0 X 10 MM
39-0050	COILED SPRING PIN 4 MM X 24 MM
41-0015	TRACITION CABLE
43-0034	KEY 1/4 X 1/4 X 1
43-0035	BELT MICRO-V 220-J - 8 GROOVES
43-0036	VERTICAL MOUNT PLASTIC BEARING IGSU EFORM-12
43-0040	KEY 5 MM X 5 MM X 25 MM
43-0041	PLASTIC THRUST WASHER
43-0044	BELT MICRO-V 190-J - 8 GROOVES
44-0195	CHEVRON TIRE ON RIM WITH TUBE 4.10" X 10" RIGHT
44-0196	CHEVRON TIRE ON RIM WITH TUBE 4.10" X 10" LEFT
70-0035	BLADE TRANSMISSION ASSY
70-0040	ARCH ASSY
70-0045	INTERMEDIATE SHAFT ASSY
70-0047	WHEEL TRANSMISSION ASSY
70-0072	KICKSTAND ASSEMBLY
70-0101	ENGINE GROUP ASSY
70-0126	ANTI-VIBRATION HANDLE
70-0136	EIGHT LOBED KNOBS WITH LOCKING SCREW
PWMA-0008	HEAVY DUTY SOLID CARBIDE BLADE TYPE 8
PWMA-0012	6 MM WIRE GUIDE ASSY

APPENDIX (70-0040)

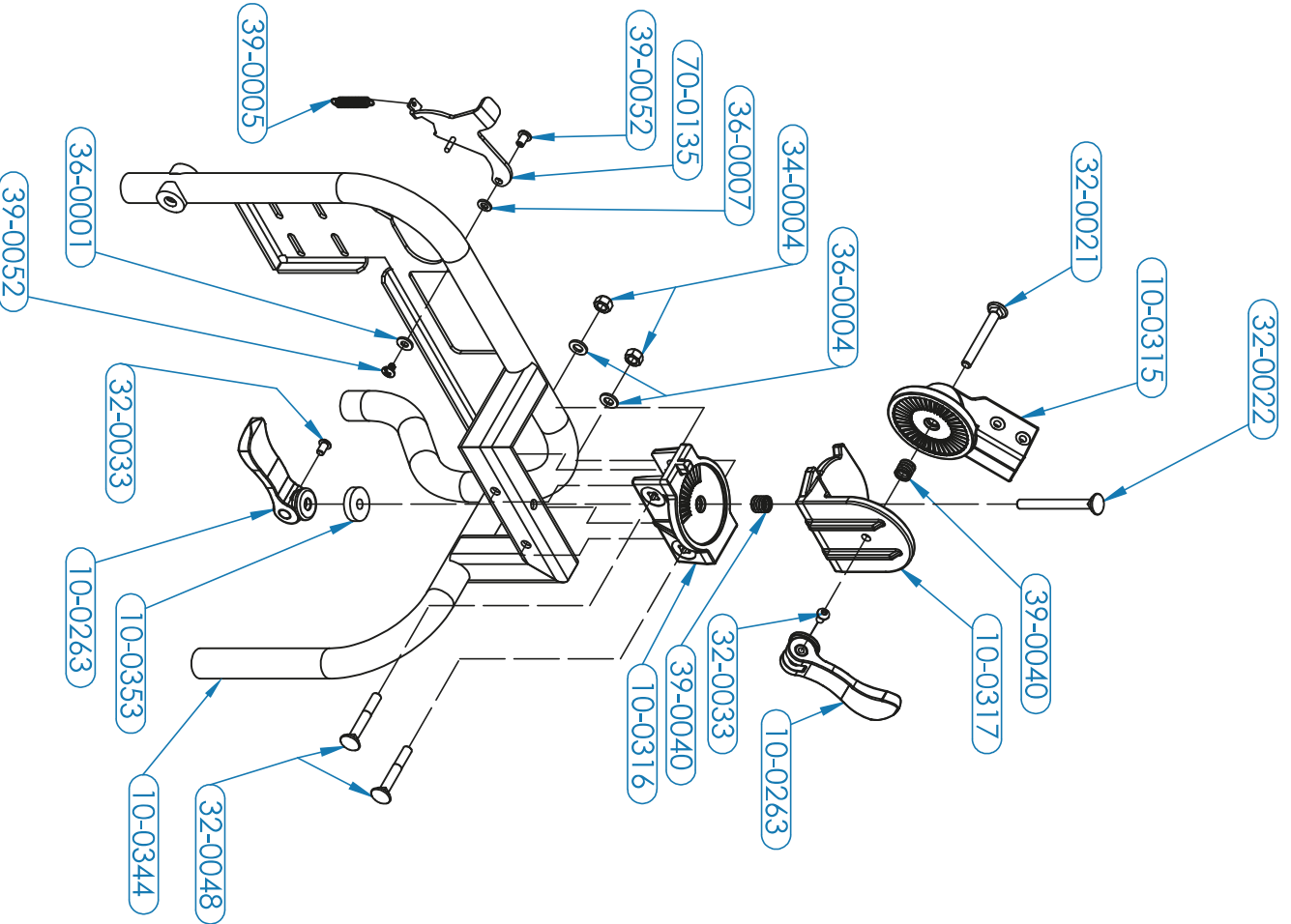

PART NO.	DESCRIPTION
10-0263	CAM LEVER
10-0315	HANDLE TOP PIVOT
10-0316	HANDLE BASE PIVOT
10-0317	HANDLE CENTER PIVOT
10-0344	ARCH FRAME
10-0353	RETAINING WASHER (.33 X 1-1/8 OD)
32-0021	CARRIAGE BOLT M8-1.25 X 65 - CLASSE 8.8- ZN
32-0022	CARRIAGE BOLT M8-1.25 X 80 - ZN
32-0033	BHCS M6-1 x 10mm - BLACK
32-0048	CARRIAGE BOLT M8-1.25 X 55 - ZN
34-0004	NUT M8-1.25 NYLON - ZN
36-0001	FLAT WASHER M6 - ZN
36-0004	FLAT WASHER M8 - ZN
36-0007	NYLON PLASTIC WASHER M6
39-0005	EXTENSION SPRING DWX-03 OD - 8.5 - SS
39-0040	COMPRESSION SPRING 0.480" X 0.500" X 0.067"
39-0052	STEEL BINDING BARREL AND SCREW 10-24, 3/8 TO 1/2 - ZN
70-0135	SPOOL HOLDER

APPENDIX (70-0126)

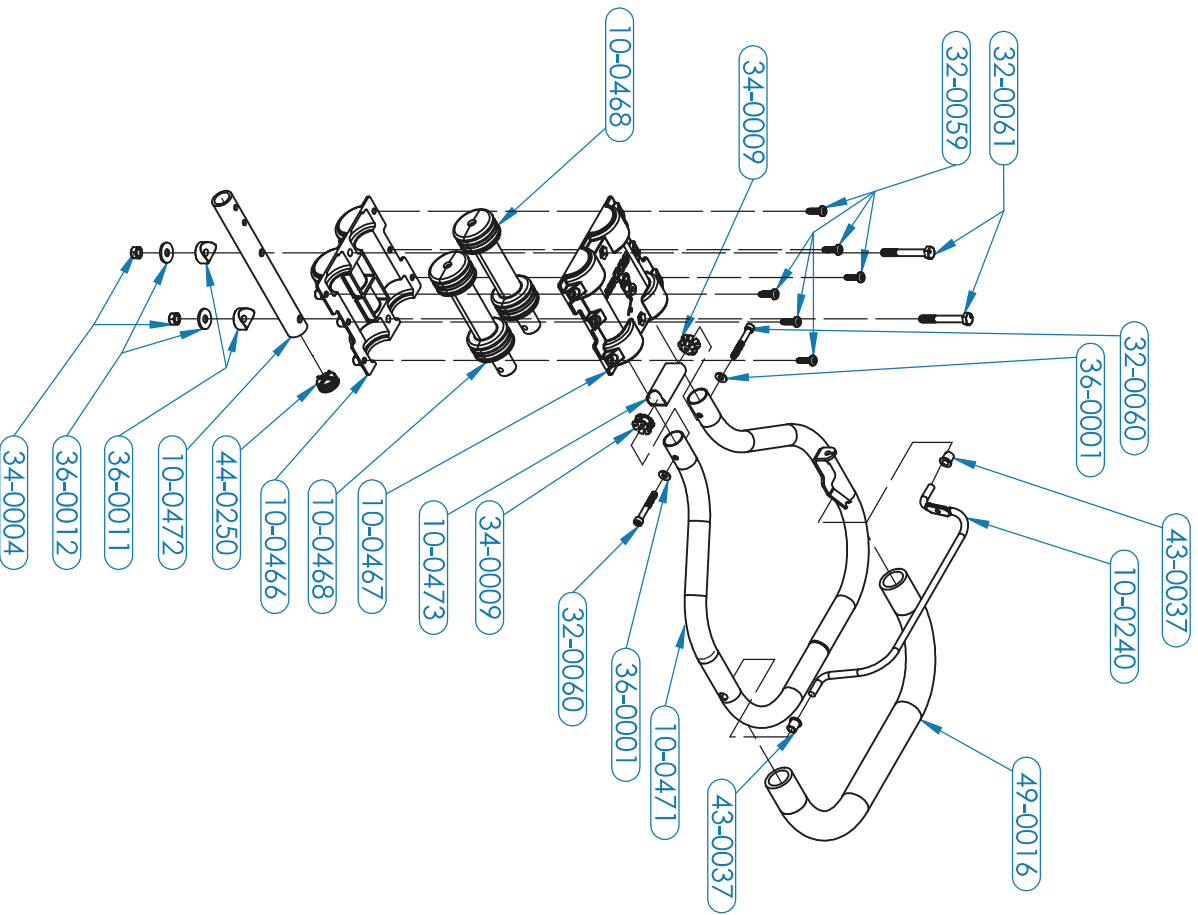

PART No.	DESCRIPTION
10-0240	TRACTION LEVER
10-0466	ANTI-VIBRATION HOUSING BOTTOM
10-0467	ANTI-VIBRATION HOUSING TOP
10-0468	ANTI-VIBRATION RUBBER WITH INNER BAR
10-0471	HANDLE WELDMENT
10-0472	JUNCTION TUBE
10-0473	HANDLE JUNCTION SPACER
32-0059	TAPTITE 2000 SP MR6-1.0 X 20mm TORX DRIVE - ZN
32-0060	SHCS M6-1.0 X 45mm - ZN
32-0061	HEX CAP SCREW M8-1.25 X 65mm - ZN
34-0004	NUT M8-1.25 NYLON - ZN
34-0009	CROWN NUT M6-1.0/21.4
36-0001	FLAT WASHER M6 - ZN
36-0011	SADDLE WASHER FOR TUBE 1" - HOLE 0.325" - ZN
36-0012	FLAT WASHER M8 OVERSIZE - ZN
43-0037	PLASTIC FLANGED BUSHING ID:5/16 X OD:7/16 X 1/2
44-0250	CAP FOR ROUND TUBE 1 OD WALL 0.134-0.083
49-0016	EPDM FOAM GRIP 1" x 20"



THE ORIGINAL
**PORTABLE
WINCH™**

www.600mh.info

info@portablewinch.com

1 888 388-7855 / +1 819-563-2193